



MODEL 1433 POWER MEAT CUTTER OPERATING AND SERVICE MANUAL



☆ IMPORTANT NOTICE ☆

This Manual contains important safety instructions which must be strictly followed when using this equipment.

TABLE OF CONTENTS

	Page
NOTICE TO OWNERS AND OPERATORS.....	1
SAFETY TIPS.....	2
INSTALLATION.....	3-7
OPERATION.....	8
TO PROCESS PRODUCT.....	9
CLEANING PROCEDURE.....	10
MAINTENANCE.....	11
GENERAL.....	11
LUBRICATION.....	12-13
WALL CHART (PART #671).....	13
PARTS DIAGRAM.....	14-22
BASE DOOR HINGE SYSTEM.....	17
SWITCH ASSEMBLIES AND SERVICE PARTS.....	23
WIRING DIAGRAMS.....	24-29
WARNING LABEL LOCATIONS ON MACHINE.....	30
WEARABLE SAW PARTS.....	31
PARTS LIST/ORDERING.....	32
PARTS ASSEMBLIES LIST /ORDERING.....	33
OPERATOR'S NOTES.....	34-35
OPERATOR'S SIGNATURE PAGE.....	36
LIMITED WARRANTY.....	37

NOTICE TO OWNERS AND OPERATORS

BIRO's products are designed to process food products safely and efficiently. Unless the operator is properly trained and supervised, there is the possibility of a serious injury. It is the responsibility of the owner to assure that this machine is used properly and safely, strictly following the instructions contained in this Manual and any requirements of local law.

No one should use or service this machine without proper training and supervision. All operators should be thoroughly familiar with the procedures contained in this Manual. Even so BIRO cannot anticipate every circumstance or environment in which its products will be used. You, the owner and operator, must remain alert to the hazards posed by the function of this equipment, particularly the SHARP MOVING BAND TYPE SAW BLADE. No one under eighteen (18) years of age should operate this equipment. If you are uncertain about a particular task, ask your supervisor.

This Manual contains a number of safe practices in the SAFETY TIP section. Additional warnings are placed throughout the Manual. Warnings related to your personal safety are indicated by:



OR



Warnings related to possible damage are indicated by:



BIRO also has provided a wall chart to be posted near the equipment. If any warning label, wall chart, or Manual becomes misplaced, damaged, or illegible, please contact your nearest Distributor or Biro directly for a replacement.

Remember, however, this Manual or the warning labels do not replace the need to be alert and to use your common sense when using this equipment.

- NOTE -

A copy of this manual is included with each Model 1433 saw.

**The descriptions and illustrations contained in this manual are not binding.
The manufacturer reserves the right to introduce any modification without
updating the manual.**

SAFETY TIPS

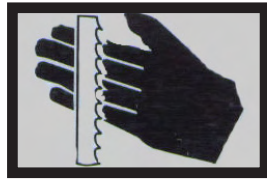

SHARP MOVING BAND TYPE SAW BLADE TO AVOID SERIOUS PERSONAL INJURY

NEVER Touch This Machine Without Training and Authorization By Your Supervisor.

ALWAYS Read Operation and Parts Manual **BEFORE** Operating, Cleaning or Servicing.

ALWAYS Keep Hands Clear of Sharp Band Type Saw Blade and Other Moving Parts.

ONLY Use a Qualified Electrician to Install According to Local Building Codes: Machines **MUST** Be Properly Grounded.

ONLY Install on Level, Non-Skid Surface in a Clean, Well-Lighted Area Away From Children and Visitors.

DO NOT Attempt to Operate This Machine Until it has Been Inspected and Demonstrated by the Seller - Recognized **BIRO** Representative.

DO NOT Alter or Modify This Machine in any Way From its Original Form. This Machine in its Original Form Meets the Intent of O.S.H.A. Applicable Standards.

NEVER Operate with Saw Guard on Saw Guide Bar in the Raised Position or the Saw Guard Removed from the Saw Guide Bar.

ALWAYS Adjust the Saw Guide Bar with Saw Guard to Within 1/2" of Product to be Cut.

ALWAYS Use Supplied Safety End Cut Pusher Plate for Smaller Products or The Last Cuts of Product.

DO NOT Use This Machine for Non-Food Products.

DO NOT Use This Machine to Cut Pigs Feet.

DO NOT Wear Gloves While Operating.

ALWAYS Turn Off, Unplug From Power Source and Perform Lockout/Tagout Procedure to This Machine **BEFORE** Removing Shrouds, Removable Guards, Covers, Doors, Fences or Panels for Cleaning, Servicing or Any Other Reason.

NEVER Leave Machine Unattended While the Saw is Running.

PROMPTLY REPLACE Any Worn or Illegible Warning Labels.

USE ONLY BIRO Parts and Accessories Properly Installed.

INSTALLATION



TO AVOID SERIOUS PERSONAL INJURY PROPERLY INSTALL EQUIPMENT IN ADEQUATE WORK AREA

- **ALWAYS** Use Qualified Technician and Electrician for Installation.
 - **ALWAYS** Install Equipment in Work area with Adequate Light and Space.
 - **ONLY** Operate on a Solid, Level, Non-Skid Surface.
 - **NEVER** Operate with Saw Guard Bar on Saw Guide Bar in the Raised Position or the Saw Guard Removed from the Saw Guide Bar.
 - **ALWAYS** Adjust Saw Guide Bar with Saw Guide to Within 1/2” of Product to be Cut.
 - **NEVER** Operate Without all Warning Labels Attached and Wall Chart Posted.
1. Read this Manual thoroughly before installation and operation. Do not proceed with installation and operation if you have any questions or do not understand anything in this Manual. Contact your local Distributor, or BIRO first.
 2. Install machine on a level, solid, non-skid surface in a well-lighted work area away from children and visitors.



ALWAYS LEVEL MACHINE BEFORE USING

3. After installing machine in operational area, it is imperative that the four adjusting leg hex bolts be adjusted to level the machine and also to eliminate rocking.
4. To assemble meat gauge plate (Part No. A14275) to the machine; Loosen the lock knob (Part No. 272-10) on the right side meat gauge bracket. Remove the meat gauge gear rack (Part No. 14272) and insert into the meat gauge plate. Be sure to hold meat gauge arm so that the release handle is depressed. Re-install the gear rack by first inserting the rectangle end into the left hand meat gauge bracket, then swing the right hollow round end of the gear into the original lock position. Upon aligning the gear rack with the capscrew (Part No. 272-11), tighten the lock knob clockwise, fastening the locking cap screw into the hollow end to the gear rack, **CHECKING** for a secure assembly. Keep gear rack well oiled with food grade oil to ensure free movement.



5. The stainless steel head (Part No. S14005C) comes detached from the base. Slide the head into the slide gibs (Part No. 260) located on the back of the base structure. Make sure the slide gibs are oiled or greased to ensure free vertical movement of the head structure.

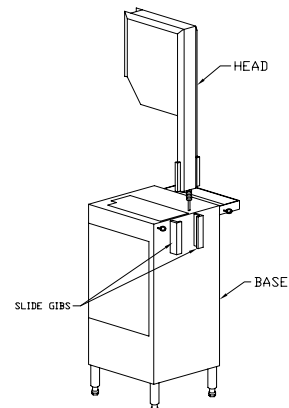

6. Place removable finger lift with saw guard assembly (Part No. A14211) on the saw guide bar (Part No. 116-22) and fasten in place with finger lift fastener knob (Part No. 211A-291Q).
7. See Lower Removable Wheel Installation and Removal Instructions for Model 1433 below.



FINGERLIFT ASSEMBLY

REMOVAL and INSTALLATION
for Self-Centering Lower Removable Wheels
(Part No. 14560-1 and 14560DF-1)

ALWAYS Turn off, unplug Machine From Power Source and Perform Lockout/Tagout Procedure to the Machine **BEFORE** Cleaning or Servicing.
 Follow disassembly procedures in the Cleaning Section of the Operating and Service Manual.
 Removal of the T-Handle and Lower Wheel will be the last 2 parts removed in the number sequence.

REMOVAL

Loosen Item No. 14746-1, T-Handle and Remove from Lower Shaft.

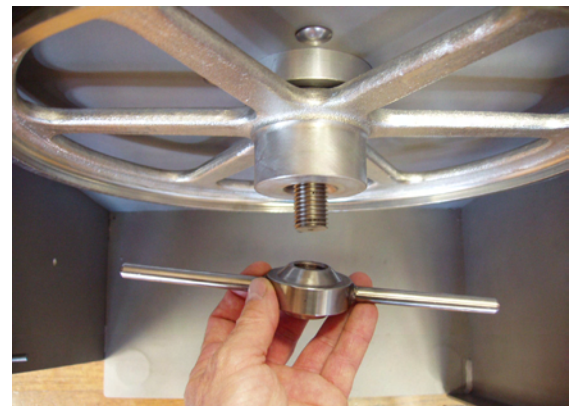

Using both hands @ 3 and 9 o'clock Positions, Pull wheel towards you with a even smooth motion.



INSTALLATION

There is a anti-rotation pin located on the lower shaft, there is a anti-rotation groove located on the back side of the lower wheel.
 Align and engage the groove of the lower wheel and the anti-rotation pin as the wheel is being installed.

Install T-Handle Lock onto Lower Shaft, Hand Tighten **SECURELY**



REMOVAL and INSTALLATION INSTRUCTIONS
for TAPERED BORE LOWER WHEELS
14560 and 14560DF

ALWAYS Turn off, unplug Machine From Power Source and Perform Lockout/Tagout Procedure to the Machine **BEFORE** Cleaning or Servicing.

Follow Disassembly Procedures in the Cleaning Section of the Operating and Service Manual. Removal of the Lower Wheel will be the last procedure.

REMOVAL

Loosen the Item No. 14746 T-Handle lock, **DO NOT REMOVE COMPLETELY FROM SHAFT.**

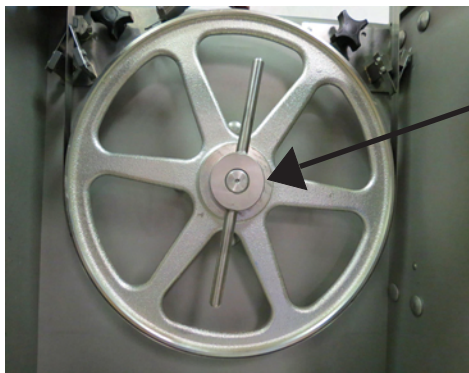

14746
T-Handle
Lock



T-Handle
Loosened

Using thumbs for leverage, pull wheel toward you with an even-smooth motion. Wheel is mounted in slip fit fashion on a tapered shaft. When the wheel is loose, complete removing T-handle lock and wheel.



14746
T-Handle
Lock

INSTALLATION



There is an alignment pin on the lower shaft. And a mating alignment groove in the hub of the lower wheel. Align the two as the wheel is being installed on the tapered shaft.

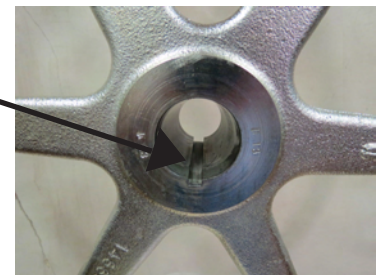

NOTE:
**TO ENSURE PROPER SAW
WHEEL ALIGNMENT, WHEEL
MUST BE REINSTALLED
ON SAME MACHINE FROM
WHICH IT WAS REMOVED.**

Replace the T-Handle Lock
HAND TIGHTEN ONLY
Reassemble the machine.



Item No. 16543 - Lower Shaft for Removable Wheel

- 7A. The Model 1433 Lower Removable Wheel has been revised to include a keyway in the bore. Also an anti rotation pin is now pressed into the lower shaft to prevent any inadvertent “spinning” of the wheel on the shaft.

NOTE- If the saw in which a new shaft is to be installed has a groove (keyway) in the bore of the lower wheel, press the taper pin (provided “loose”) into the hole in the side of the shaft (see sketch). If there is no groove (keyway) in the bore of the lower wheel, discard the taper pin and use the shaft without the pin.

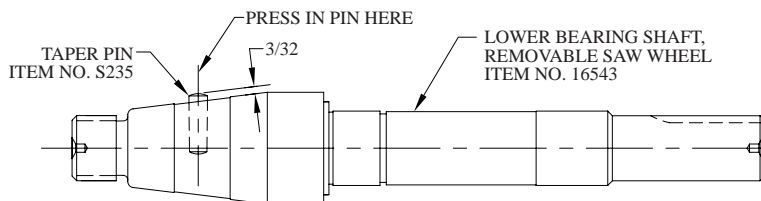

SHARP SAW BLADE. HANDLE WITH EXTREME CAUTION.

8. Place blade on cutter: Hang upper wheel assembly (Part No. A14003u335-6) on the hinge bracket (Part No. 71-1). Lift the nylon filler (Part No. 177). Hang blade on the upper wheel and hold with right hand. With the left hand force the blade between the front blade cleaners (Part No. 131), located below the nylon filler. Lower the nylon filler and insert the back of the blade in the upper saw guide (Part No. 602B). The blade has already dropped over the lower wheel. With the right hand force the back of the blade between the rear blade cleaners (Part No. 131). The blade is now ready to be tightened. Press down on the ratchet arm (Part No. 10-1) located at the rear of the base structure. Turn the upper wheel slowly by hand to ensure proper tracking of the saw blade on the wheels. Tighten to proper tension. When the tension gauge (Part No. 197), located at the bottom rear of the head becomes tight laterally the blade is at proper tension.
9. The side platter bracket (Part No. S14214) is packed loose in the machine and must be installed on the left side of the base structure with the supplied hardware and check for proper adjustment. Stationary platter must be flat.
10. The stationary platter (Part No. A14163) is placed on top of the base structure and held in place by two push-pull hold down rods (Part No. 14212W), located at the rear of the base.
11. The sliding meat carriage assembly (Part No. A16155EZ) is installed by turning the movable stop assembly (Part No. A16200) clockwise. After the carriage assembly is in the channel for operation, turn the movable stop counterclockwise to lock.
12. Post SAFETY TIPS wall chart within easy view of operator. Keep Manual available to operator.
13. Machine MUST be properly grounded. Use qualified electrician to install according to building codes.

WIRING MOTOR

- A. Interchange of motor current is made in motor outlet box. Leads are properly marked. Changing instructions are on motor plate or motor box outlet box.
- B. All cutters are wired 220 volts unless otherwise specified. Be sure motor specifications (voltage, cycle, phase) match power supply line. Be sure line voltage is up to specification.
- C. Connect leads to machine in a manner that will be approved by local electrical inspectors.
- D. We recommend no less that No. 12 Ga. wire. If the leads are too light, machine may not have sufficient cutting power and/or speed.
- E. The V-belt is packed loose in machine to prevent deformation, and must be installed on pulley at time of wiring motor.
- F. The BIRO Manufacturing Company is not responsible for permanent wiring, connection or installations.



NOTE TO OWNER AND ELECTRICIAN: IF THIS MACHINE IS NOT CORD AND PLUG CONNECTED TO THE ELECTRICAL SUPPLY SOURCE, THEN IT SHOULD BE EQUIPPED WITH, OR CONNECTED TO, A LOCKABLE, MANUALLY OPERATED DISCONNECT SWITCH (1010.147 OSHA).



KEEP HANDS CLEAR OF SHARP MOVING BAND TYPE SAW BLADE.

14. Make sure saw guide bar with saw guard is in its lowest position. Close head and base doors.
15. Push button and check for proper phasing of motor. Blade should be traveling down through saw guide.
16. Watch for proper tracking of blade. Back of blade should be centered in hole in saw guide in stationary bar (Part No S119A). Push stop button to stop machine.
17. Check placement of all warning labels, wall chart and Manual. Machine is ready for trained operators to process product.
18. Contact your local Distributor or BIRO directly if you have any questions or problems with the installation or operation of this machine.

WARNING LABELS AND WALL CHART FOR BIRO POWER CUTTERS

SEE PAGE 30 FOR LOCATIONS ON THIS MACHINE



Item No. 653PC-E



Item No. 653PC-SP



Item No. 16716

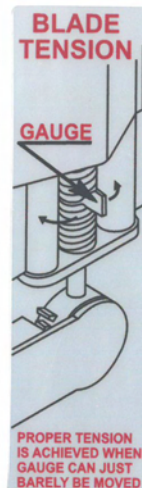

Item No. 710



Item No. 708

OPERATION

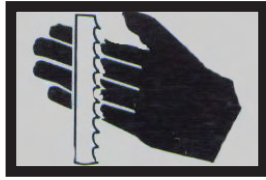

SHARP MOVING BAND TYPE SAW BLADE TO AVOID SERIOUS PERSONAL INJURY

***ONLY** Properly Trained Personnel Should Use This Equipment.*

***ALWAYS** Read Operating and Parts Manual **BEFORE** Operating.*

***ALWAYS** Keep Hands Clear of Band Saw Type Blade and Other Moving Parts.*

***DO NOT** Tamper With, Bypass, Alter, or Modify this Equipment in Any Way or Form.*

***DO NOT** Alter or Modify This Machine in any Way From its Original Form. This Machine in its Original Form Meets the Intent of O.S.H.A Applicable Standards.*

***NEVER** Operate with Saw Guard on Saw Guide Bar in the Raised Position or the Saw Guard Removed from the Saw Guide Bar.*

***ALWAYS** Adjust the Saw Guide Bar with Saw Guard to Within 1/2" of Product to be Cut.*

***ALWAYS** Use Safety End Cut Pusher Plate for Smaller Products or The Last Cuts of Product.*

***DO NOT** Use This Machine for Non-Food Products.*

***DO NOT** Use this Machine to Cut Pigs Feet.*

***DO NOT** Wear Gloves While Operating.*

***ALWAYS** Turn Off, unplug from Power Source and Perform Lockout/Tag Out Procedures Before Cleaning, Servicing or When Not in Use.*

***NEVER** Leave Machine Unattended While the Saw is Running.*

***NEVER** Operate Without All Warning Labels Properly Affixed to Machine.*

A. FOOD HANDLING TO PREVENT CONTAMINATION

1. **ALWAYS** wash hands thoroughly with warm soap and water before and after handling raw fish, poultry or meats.
2. **ALWAYS** clean and sanitize all utensils and surfaces that have been in contact with raw products.
3. **ALWAYS** store cold foods at or below 45 deg. F (7.2 deg. C).

B. TO PROCESS PRODUCT

1. Before starting power cutter, adjust saw guide bar with saw guard to within 1/2" of product to be cut. "B"

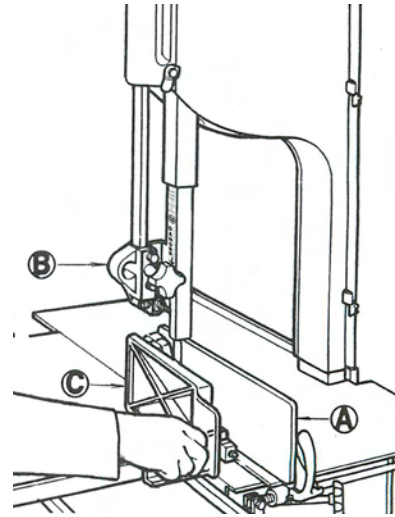
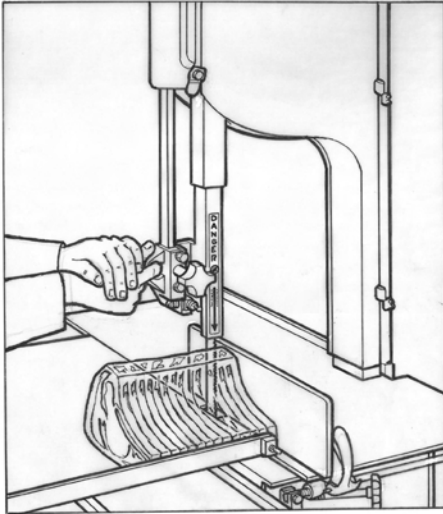

DO NOT WEAR GLOVES WHILE OPERATING

2. Make sure all doors are closed and locked.
3. Adjust meat gauge plate forward to desired thickness of cut. "A"
4. Push start button and watch blade for proper tracking.
5. Stand in front of the power cutter, place product on the meat carriage. Pay attention to position of your hands. Keep hands clear of moving band type saw blade. Leaning lightly against the scalloped front edge of meat carriage, hold the product firmly in right hand with product face flush against the meat gauge plate. Move the meat carriage from right to left at a steady rate until fully past the saw blade. Use left hand to remove and stack cut product, **NEVER REACH IN FRONT OF BAND TYPE SAW BLADE**. On the return stroke, pull the product slightly toward you to clear the blade.



NEVER REACH OR GRAB FOR PRODUCT IN FRONT OF MOVING BAND TYPE SAW BLADE

6. **ALWAYS** use the Safety End Cut Pusher Plate for smaller products or the last cuts of product. "C"
The pusher plate is supplied as standard on all BIRO power cutters.
7. When finished cutting, push stop button. Perform lockout/tag out procedure.

CLEANING



SHARP MOVING BAND TYPE SAW BLADE TO AVOID SERIOUS PERSONAL INJURY

- **ALWAYS** Turn Off, Unplug From Power Source and Perform Lockout/Tagout Procedure to This Machine **BEFORE** Cleaning or Servicing.
- **ONLY** Use Recommended Cleaning Equipment, Materials and Procedures.
- **NEVER** Spray Water or Other Liquid Substances directly at Motor, Power Switch or any Other Electrical Components.
- **ALWAYS** Thoroughly Clean Equipment at Least Daily.

CLEANING THE BIRO POWER CUTTER:

Disconnect electrical power to the machine before cleaning. Parts to be removed have been made accessible and can be removed without tools. Notice in the drawing below that all parts are numbered. Each part should be removed for cleaning in the numbered sequence shown. To ensure cleaner cuts, keep the parts on the cleaning system in good condition. Parts on the cleaning system which should be checked weekly, and changed as required are as follows: Wheel Cleaners (Part No. 179), Saw Cleaners (Part No. 131), Saw Guide in Stationary Bar (Part No. S119A), Upper Saw Guide (Part No. 602B), Lower Blade Back-Up Guide (Part No. S608), and Nylon Filler (Part No. 177).

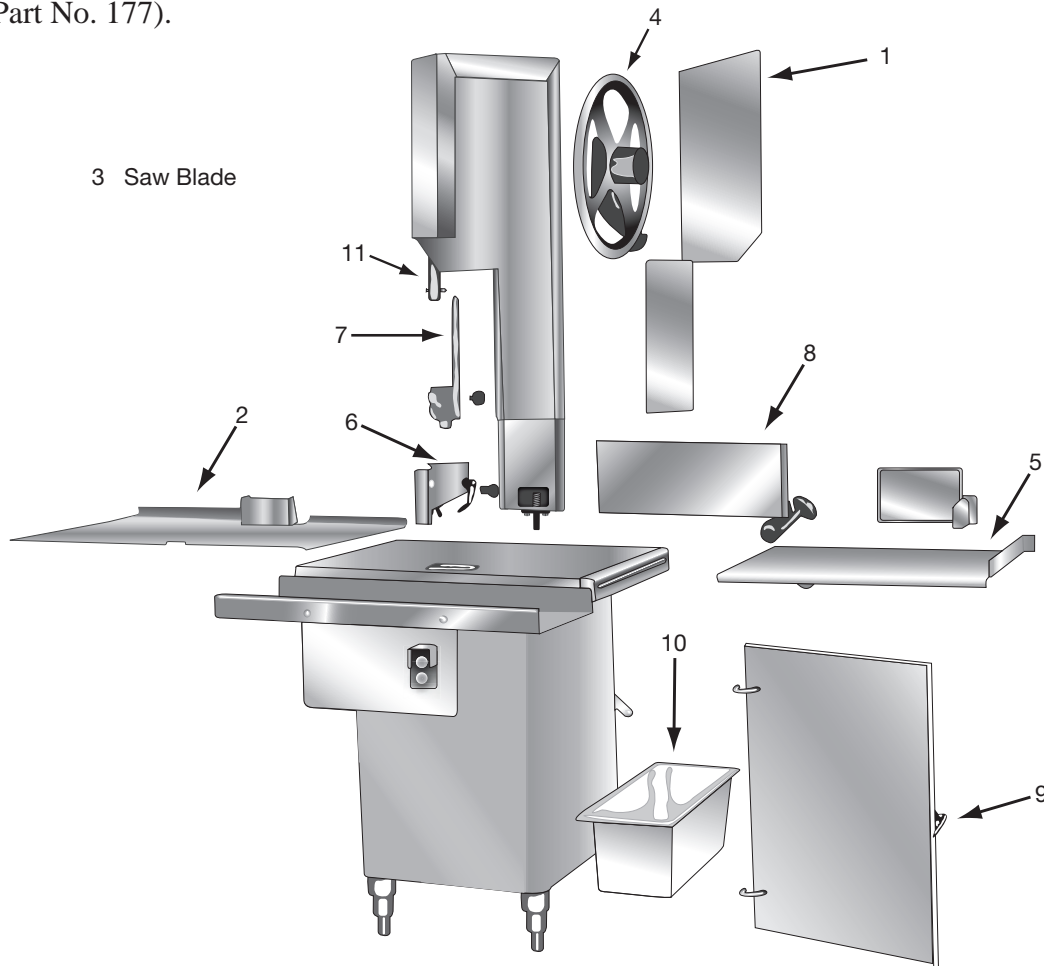

MAINTENANCE

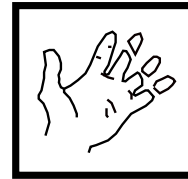

SHARP MOVING BAND TYPE SAW BLADE TO AVOID SERIOUS PERSONAL INJURY

- **ALWAYS** Turn Off, Unplug From Power Source and Perform Lockout/Tagout Procedure to This Machine **BEFORE** Cleaning or Servicing.
- **NEVER** Touch This Machine Without Training and Authorization By Your Supervisor.
- **ALWAYS** Keep Hands Clear of Band Type Saw Blade and Other Moving Parts.
- **NEVER** Bypass, Alter, or Modify This Equipment in Any Way From Its Original Condition.
- **PROMPTLY REPLACE** Any Worn or Illegible Warning Labels.
- **USE ONLY GENUINE BIRO** Parts and Accessories Properly Installed.

A. GENERAL

1. Machine should be generally inspected every time it is cleaned (at least daily) to ensure that it is in good condition and has not been damaged or tampered with.
 - a. **SAW WHEELS:** Clean outer diameter grooves daily. Check for cracks, gouges or wear on the flange and grooves.



**DO NOT IMMERSE UPPER WHEEL
ASSEMBLY IN WATER**

- b. **WHEEL CLEANER ASSEMBLIES:** Check condition of fiber cleaner, change every four(4) weeks. Check condition of tension spring, replace as needed.
- c. **REMOVABLE FINGER LIFT ASSEMBLY:** Check condition of saw guard, make sure mounting bolts are tight and the "DANGER EXPOSED BLADE" decal is affixed and legible. Check condition of upper saw guide (Part No. 602B), replace every six(6) months. Check adjustment of upper saw guide. Should be 1/32" between back of blade and saw guide carbide.



**NEVER USE THIS MACHINE WITHOUT PROPERLY INSTALLED
AND FUNCTIONING SAW GUIDE BAR AND SAW GUARD**

- d. **SAW GUIDE BAR:** Check condition of bar for coating peeling and wear, replace as necessary. Check saw guide bar spring for proper tension. The spring should hold the bar in any desired position in its travel. Replace saw guide bar spring (Part No. 193) as necessary using instructions on following page.

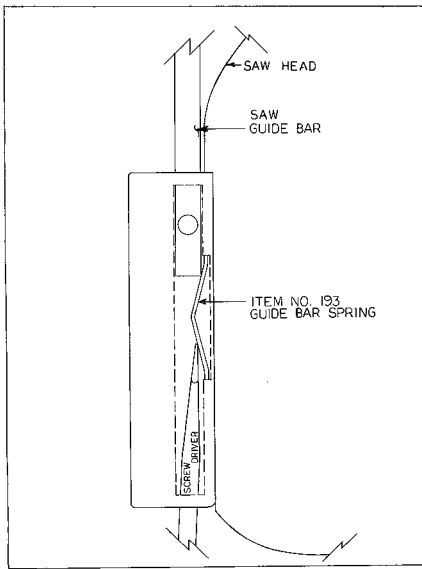

1. Remove the finger lift fastener knob and the finger lift assembly.
2. Remove the finger lift fastener stud.
3. Push the saw guide bar up and out of the top of the head structure.
4. Remove the saw guide bar spring.
5. Clean and lubricate the babbitt pocket area (the square indented area that seats the saw guide bar spring).
6. Lower the new saw guide bar spring through the top of the babbitt pocket area and guide the spring into position with a standard screwdriver. (NOTE: drawing)
7. While holding the saw guide bar spring in position, re-enter the saw guide bar from the top compressing the saw guide bar spring slightly until the saw guide bar slides past the spring.
8. Replace the finger lift fastener stud, the finger lift assembly and the finger lift fastener knob.
9. Test by making several adjustments.

- e. **STATIONARY BAR ASSEMBLY:** Check condition of nylon filler (Part No. 177), change every four (4) weeks. Check condition of saw guide (Part No. S119A), check tracking of blade through guide, back of blade should be centered in hole, replace every six (6) months. Check condition of lower blade back-up guide (Part No. S608). Check adjustment of back-up guide, should have 1/32" gap between back of blade and saw guide carbide. Replace every six (6) months.
- f. **SAW CLEANERS:** Check condition of blade cleaners, replace every four (4) weeks.
- g. **RATCHET ASSEMBLY:** Check for smooth operation through full range of travel. Check condition of trigger spring, replace as necessary.
- h. **SLIDE GIBS:** Check that head structure moves freely up and down. Check for side to side and front to rear tolerance. Adjust as required. Grease every four (4) weeks.
- i. **MEAT GAUGE ASSEMBLY:** Check free movement of meat gauge plate on gear rack. Gear rack to be kept lubricated at all times with light food grade oil. Check operation of release handle. Check that worm gear engages properly with gear rack. Check tension of release handle spring, replace as necessary.
- j. **MEAT CARRIAGE ASSEMBLY:** Check for free movement through full range of travel. Check for side to side tolerance, adjust as necessary. Check condition and grease bearings, replace as necessary. Check condition of thumb guard, replace as necessary.
- k. **SAFETY ITEMS:** Safety end cut pusher plate is with machine and accessible. All warning labels are present, properly affixed and legible. Model and Serial Number plate properly affixed and legible. Wall poster within operator's view from machine. Manual accessible to operator.

B. LUBRICATION:

1. **UPPER WHEEL BEARINGS:** Grease every four (4) months. Change grease every twelve (12) months.
2. **LOWER BEARING HOUSING:** Grease every four (4) months. Change grease every twelve (12) months.
3. **SLIDE GIBS:** Grease every four (4) weeks.
4. **MEAT CARRIAGE BEARINGS:** Grease every four (4) weeks.
5. **SAW GUIDE BAR:** Oil daily with food machine oil.
6. **MEAT GAUGE GEAR RACK:** Oil daily with food machine oil.

**-NOTE-
USE SHELL CASSIDA
GREASE EPS-2**

USE BIRO No. 374 GREASE FOR RE-GREASING SEE INSTRUCTIONS BELOW

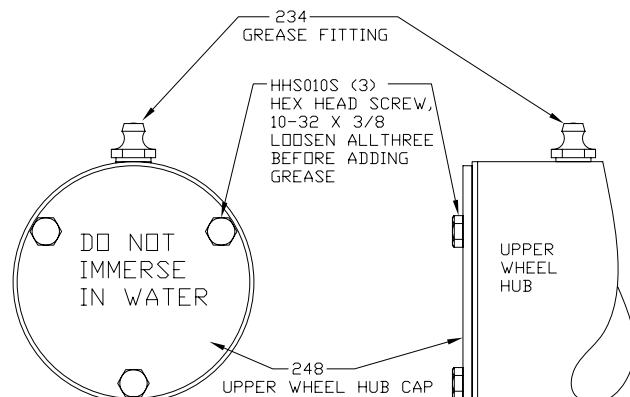

When lubricating the upper wheel bearing it is important that the three hex head screws securing the upper wheel hub cap be loosened slightly before attempting to pump grease into the grease fitting. Loosening the screws allows for an escape of old broken down grease and air from the bearing cavity. Failure to loosen the screw before greasing the upper bearings can cause the upper shaft seal to be dislodged from the upper wheel allowing grease to escape and moisture to get into the cavity. When finished greasing the bearings, retighten the three screws. Take care to also clean off any grease that was forced out of the cavity during greasing.

7. **MOTOR BEARINGS:** Bearing grease will lose its lubricating ability over time, not suddenly. The lubricating ability of a grease (over time) depends primarily on the type of grease, the size of the bearing, the speed at which the bearing operates and the severity of the operating conditions. Good results can be obtained if the following recommendations are used in your maintenance program.

A high grade ball or roller bearing grease should be used. Recommended grease for standard service conditions is Polyrex EM (Exxon Mobil).

Equivalent and compatible greases include: Texaco Polystar, Rykon Premium #2, Pennzoil Pen 2 Lube, and Chevron SRI.

Recommended lubrications intervals is every 9 months with the equivalent of two (2) teaspoons of grease.

PART NUMBER 671

WALL CHART “BAND SAW SAFETY GUIDELINES”

ATTACH TO WALL IN VICINITY OF MACHINE IN EASY VIEW OF OPERATOR



WARNING

ONLY TRAINED OPERATORS SHOULD USE THIS EQUIPMENT

This Saw Contains A Sharp Blade.
To Avoid Serious Injury:

1. Inspect Before Operating:

- Gauge Plate (A) and Blade Guard Are Secure.
- All Warning Labels And Guards Are In Place.
- The Guide Bar (B) Is Adjusted to 1/2 Inch Above The Product To Be Cut

2. While Cutting:

- Keep Hands And Fingers Away From Blade.
- Keep Product Securely Against Gauge Plate (A).
- Use End Cut Pusher Plate (C) When Making Final Cuts. Item No. 256P.

3. Before Cleaning:

- Turn Off Power And Follow Lockout / Tagout Procedure.
- Remove Saw Blade.
- Use Extra Care When Handling The Saw Blade.

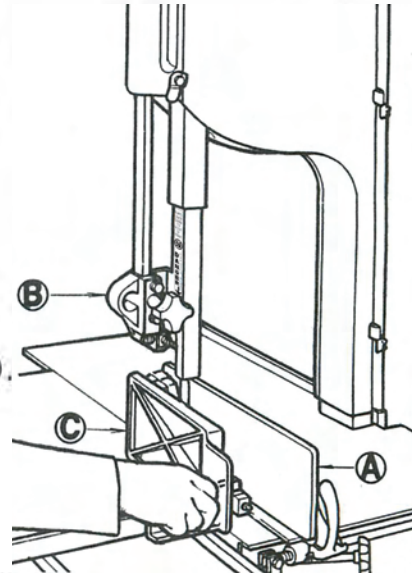

USE YOUR MEAT SAW SAFELY!

SEE PARTS AND SERVICE MANUAL SUPPLIED WITH MACHINE FOR ADDITIONAL SAFETY INFORMATION.

#671

NOTE:

ALWAYS REPORT MACHINE
SERIAL NUMBER WHEN
ORDERING PARTS

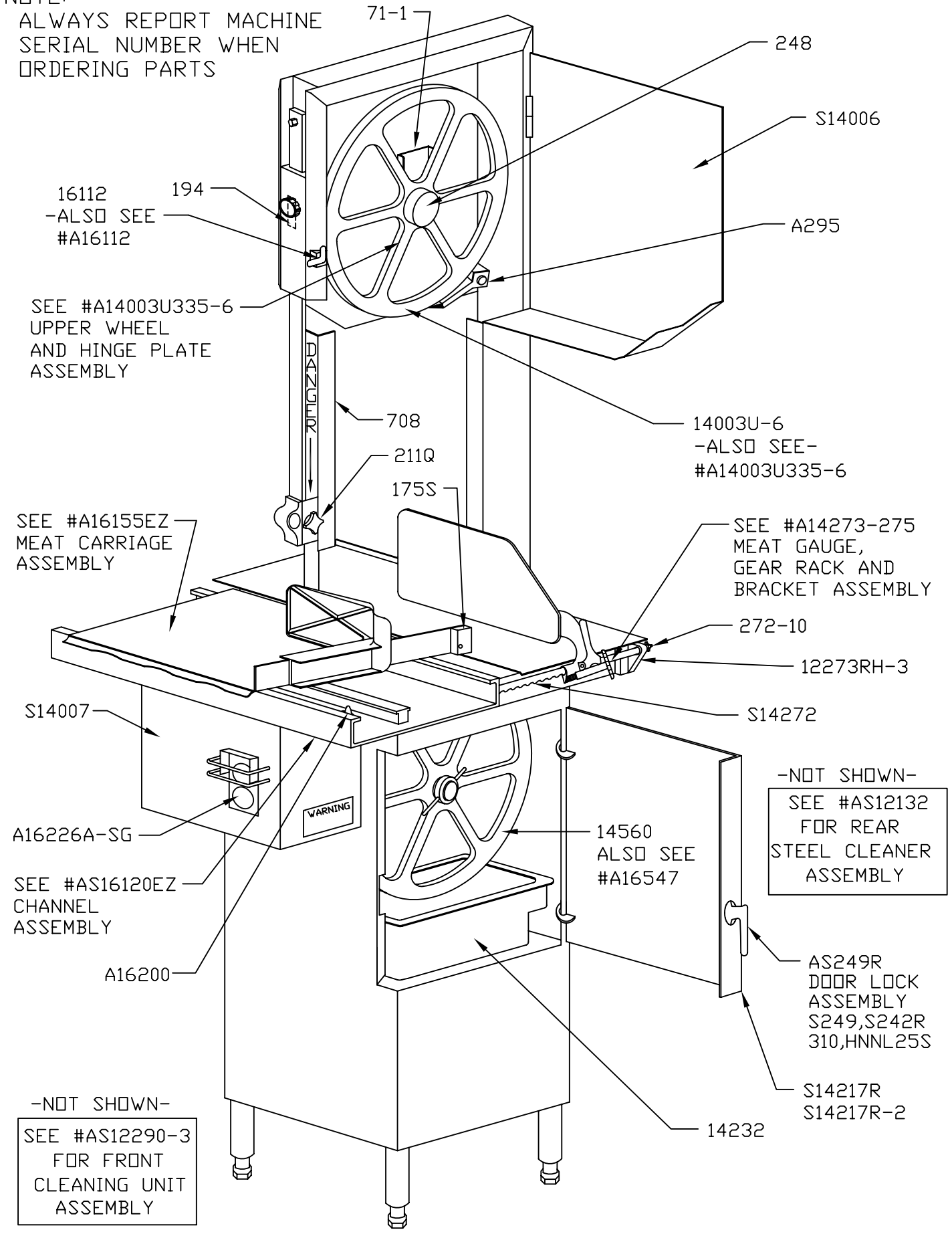

SPLIT
PLATTER
ASSEMBLY

A14163-4

A14163-5

NOTE:

ALWAYS REPORT MACHINE SERIAL
NUMBER WHEN ORDERING PARTS.

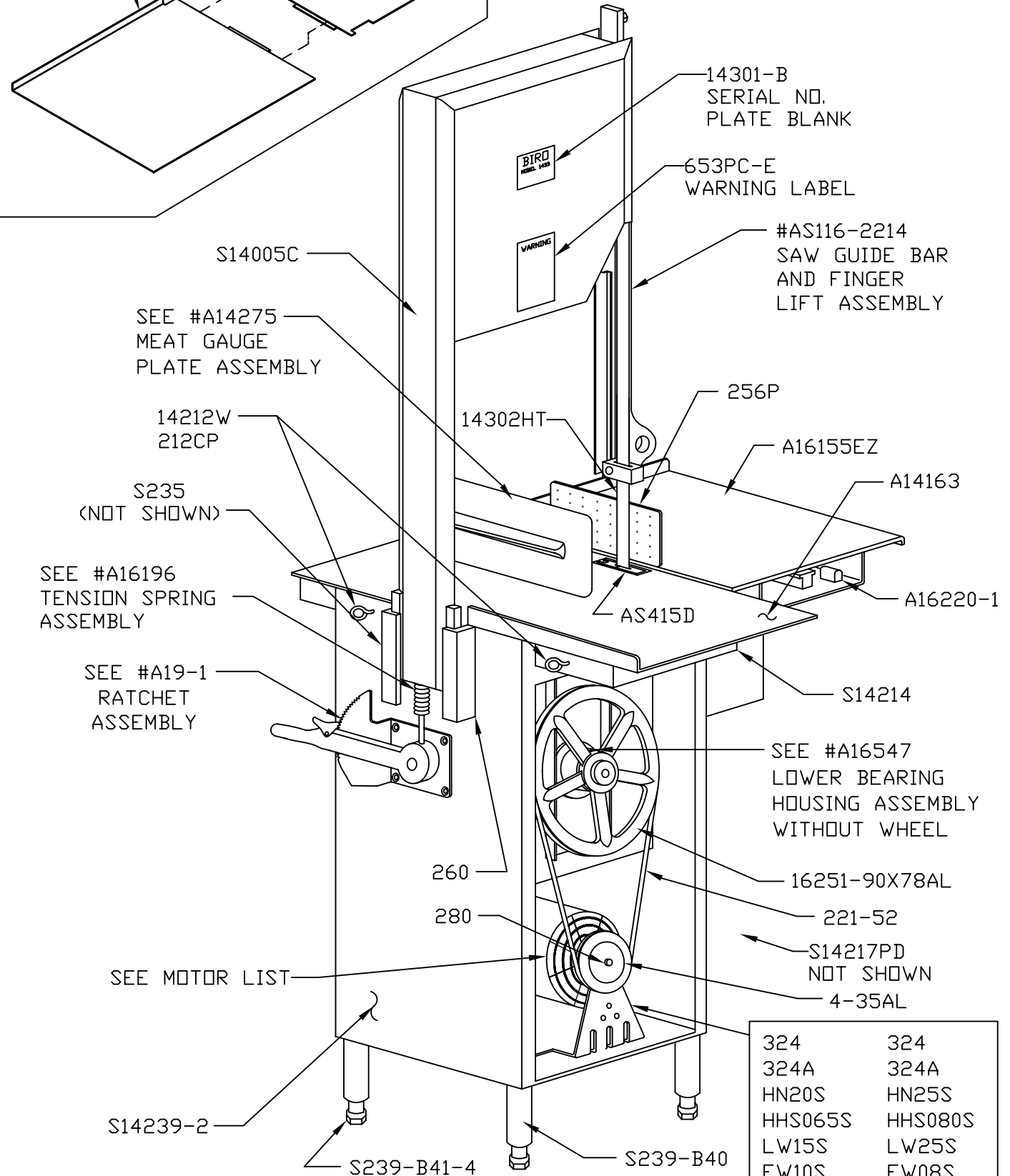

14301-B
SERIAL NO.
PLATE BLANK

653PC-E
WARNING LABEL

#AS116-2214
SAW GUIDE BAR
AND FINGER
LIFT ASSEMBLY

S14005C

SEE #A14275
MEAT GAUGE
PLATE ASSEMBLY

14212W
212CP

S235
(NOT SHOWN)

SEE #A16196
TENSION SPRING
ASSEMBLY

SEE #A19-1
RATCHET
ASSEMBLY

14302HT

256P

A16155EZ

A14163

AS415D

A16220-1

S14214

SEE #A16547
LOWER BEARING
HOUSING ASSEMBLY
WITHOUT WHEEL

260

16251-90X78AL

280

221-52

SEE MOTOR LIST

S14217PD
NOT SHOWN

4-35AL

S14239-2

S239-B41-4

S239-B40

324	324
324A	324A
HN20S	HN25S
HHS065S	HHS080S
LW15S	LW25S
FW10S	FW08S

AS14005C STAINLESS STEEL HEAD & DOOR ASSEMBLY

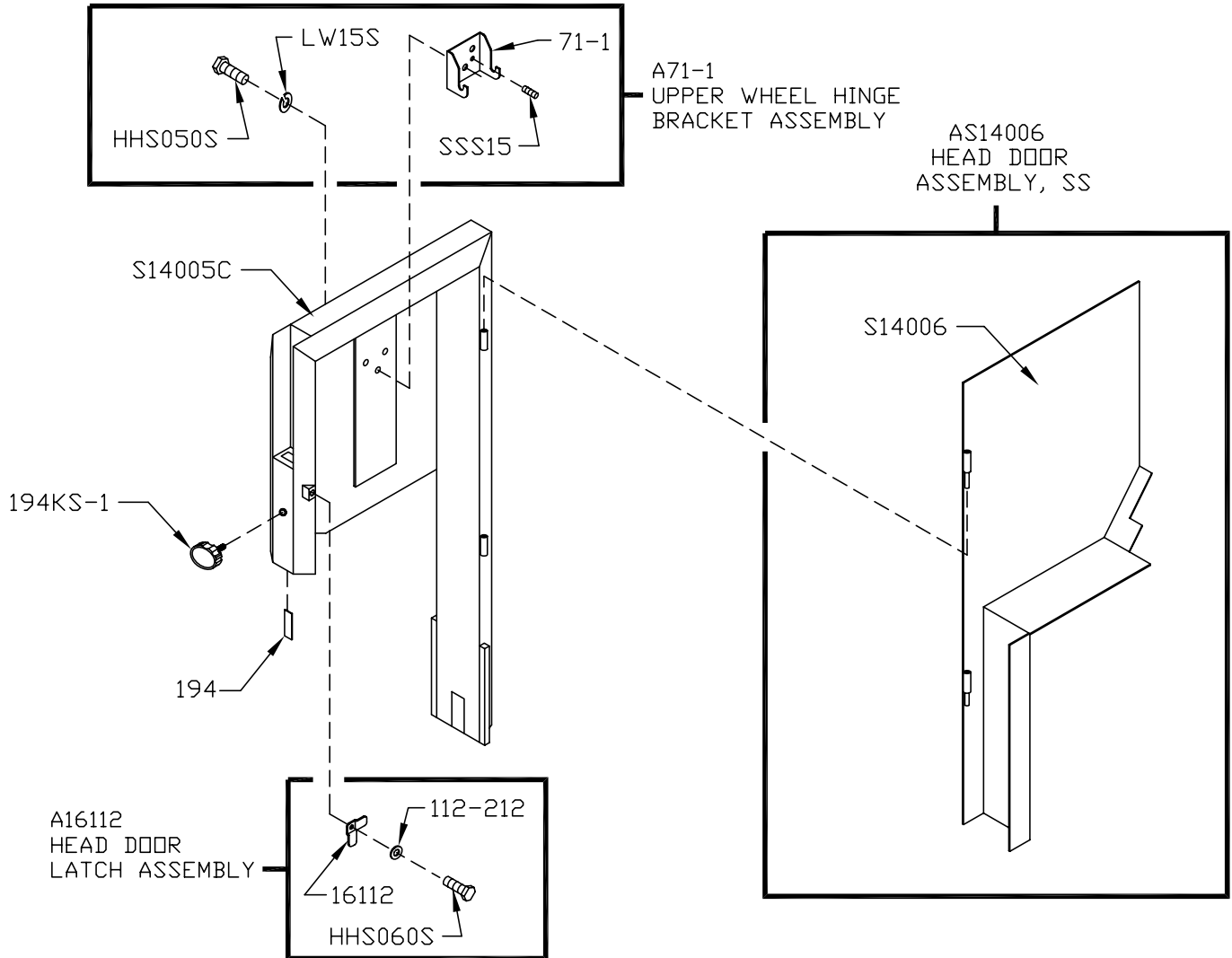

Item No.	Description
A16112	Head door latch assembly
AS14005C	Head & door assembly, SS
AS14006	Head door assembly, SS
A71-1	Upper wheel hinge bracket assembly
HHS050S	Hex head screw, 5/16-18 x 5/8 SS
LW15S	Lock washer, 5/16 SS
S14005C	Head, SS

Item No.	Description
S14006	Head door SS
SSS15	Set screw, 5/16-18 x 5/16 cup point
112-212	Waved washer
16112	Head door latch
194	Saw guide bar lock pad, brass
194KS-1	Saw guide bar lock knob assembly
71-1	Upper wheel hinge bracket

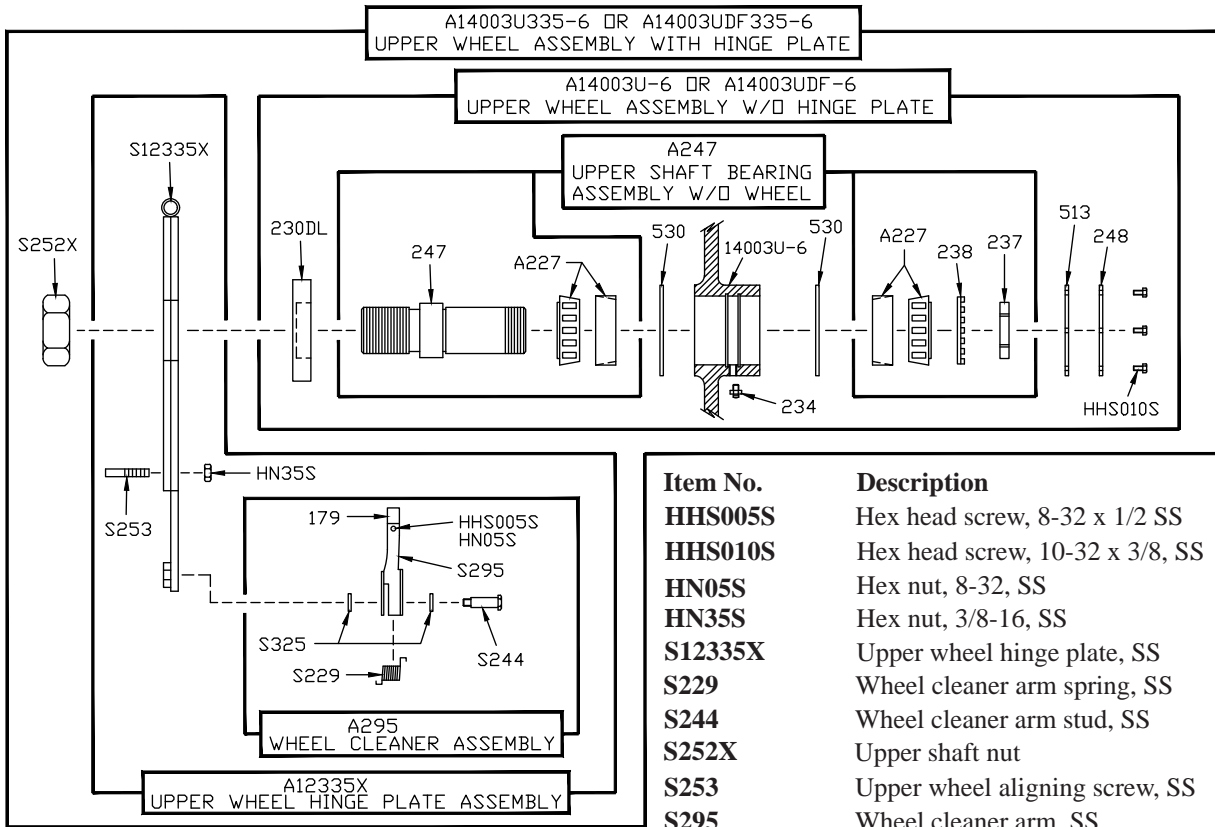

Item No.	Description
HHS005S	Hex head screw, 8-32 x 1/2 SS
HHS010S	Hex head screw, 10-32 x 3/8, SS
HN05S	Hex nut, 8-32, SS
HN35S	Hex nut, 3/8-16, SS
S12335X	Upper wheel hinge plate, SS
S229	Wheel cleaner arm spring, SS
S244	Wheel cleaner arm stud, SS
S252X	Upper shaft nut
S253	Upper wheel aligning screw, SS
S295	Wheel cleaner arm, SS
S325	Wheel cleaner arm stud washer, SS
14003U-6	Upper wheel, 14", 6 spoke
14003UDF-6	Upper wheel, 14", double flange, 6 spoke
179	Wheel cleaner
230DL	Upper shaft seal, double lip
234	Grease fitting
237	Upper shaft castellated lock nut
238	Upper shaft castellated lock washer
247	Upper shaft
248	Upper wheel hub cap
513	Upper wheel hub gasket
530	Retaining ring, (2 req.)

Item No.	Description
A14003U335-6	Upper wheel assembly w/ hinge plate
A14003UDF335-6	Upper wheel assembly - double flange w/ hinge plate
A14003U-6	Upper wheel assembly w/o hinge plate
A14003UDF-6	Upper wheel assembly - double flange w/o hinge plate
A12335X	Upper wheel hinge plate assembly
A227	Upper bearing cup/cone assembly
A247	Upper shaft bearing assembly w/ spacer
A295	Wheel cleaner assembly

Base Door Hinge System on the Model 1433 and 1433FH Series has been changed from an internal "plate & pin" system to an external "barrel & pin" system (see sketch below).

Old Style

Hinged Base Door - #S14217R
Before Serial No. 2218

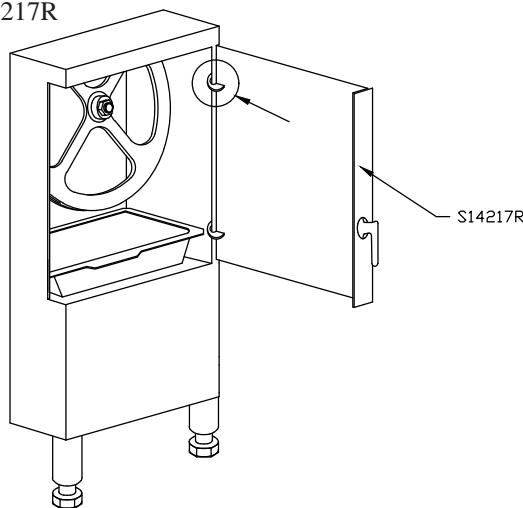

New Style

Hinged Base Door - #S14217R-2
Starting with Serial No. 2218

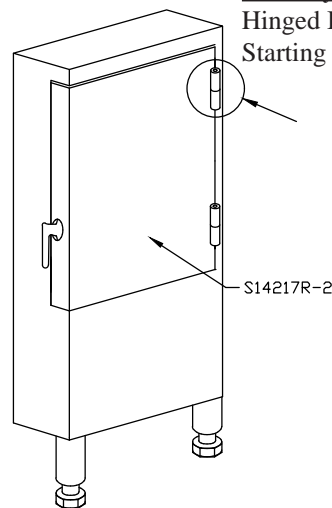

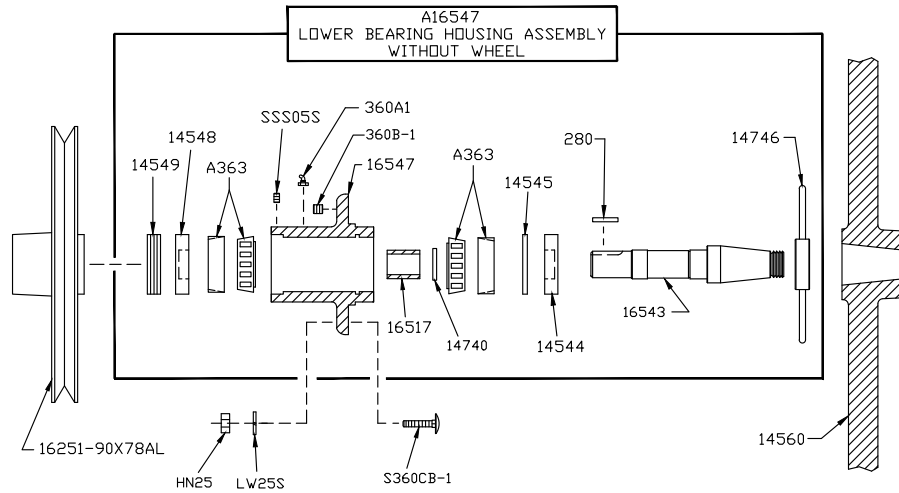

Item No.	Description	Item No.	Description
A16547	Lower bearing housing assembly w/o wheel	14560	Lower saw wheel, 14"
A363	Lower bearing cup/cone assembly	14560DF	Lower saw wheel, 14", double flange
HN35S	Hex nut, 3/8 -16, SS	14740	Retaining ring- external
LW20S	Lock washer, 3/8, SS	14746	T- handle lock, removable lower wheel
SSS05S	Set screw cup, SS, 10-24 x 3/8	16251-90X78AL	Pulley, upper V-belt 9 x 7/8 AL
14544	Grease seal, 1 1/2 ID	16517	Inner race spacer, removable wheel
14545	Retaining ring, internal, 2-7/16 ID	16543	Shaft, lower saw wheel
14548	Grease seal, 7/8 ID	16547	Lower bearing housing, removable wheel
14549	Lower bearing housing cap	280	Key
14550	Adjustment screw, lower bearing housing	360A1	Grease fitting angular
14551	Hex jam nut, 5/8 -11, SS	360B-1	Set screw 1/2-13

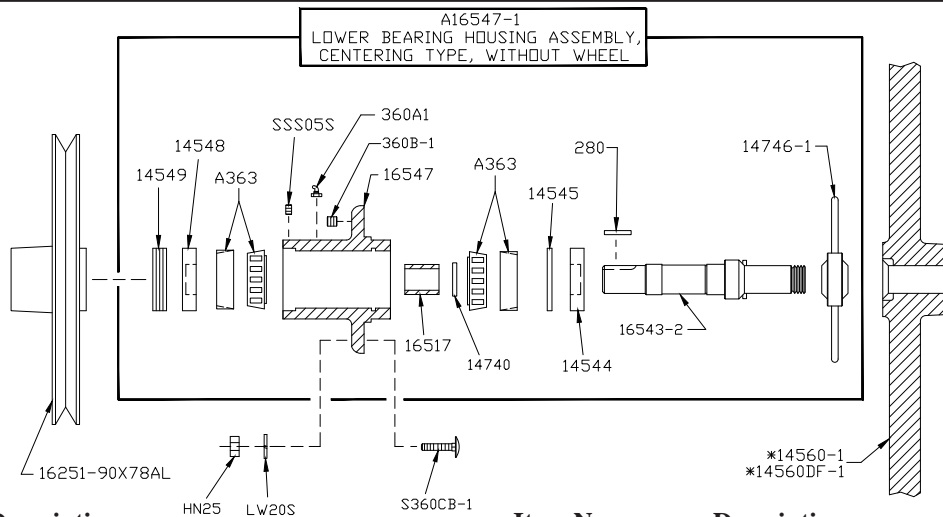

Item No.	Description	Item No.	Description
A16547-1	Lower bearing housing assembly w/o wheel	*14560-1	Lower saw wheel, 14", NA, Must Order 14560-2, 16543-3, 14746-2
A363	Lower bearing cup/cone assembly	*14560DF-1	Lower saw wheel, 14", DF NA, Must Order 14560-2, 16543-3, 14746-2
HN35S	Hex nut, 3/8 -16, SS	14740	Retaining ring- external
LW20S	Lock washer, 3/8, SS	14746-1	T- handle, removable lower wheel
SSS05S	Set screw cup, SS, 10-24 x 3/8	16251-90X78AL	Pulley, upper V-belt 9 x 7/8 AL
S360CB-1	Carriage bolt, 3/8 -16 x 1 1/4, SS	16517	Inner race spacer, removable wheel
14544	Grease seal, 1 1/2 ID	16543-2	Shaft, lower saw wheel
14545	Retaining ring, internal, 2-7/16 ID	16547	Lower bearing housing, removable wheel
14548	Grease seal, 7/8 ID	280	Key
14549	Lower bearing housing cap	360A1	Grease fitting angular
14550	Adjustment screw, lower bearing housing	360B-1	Set screw 1/2-13
14551	Hex jam nut, 5/8 -11, SS		

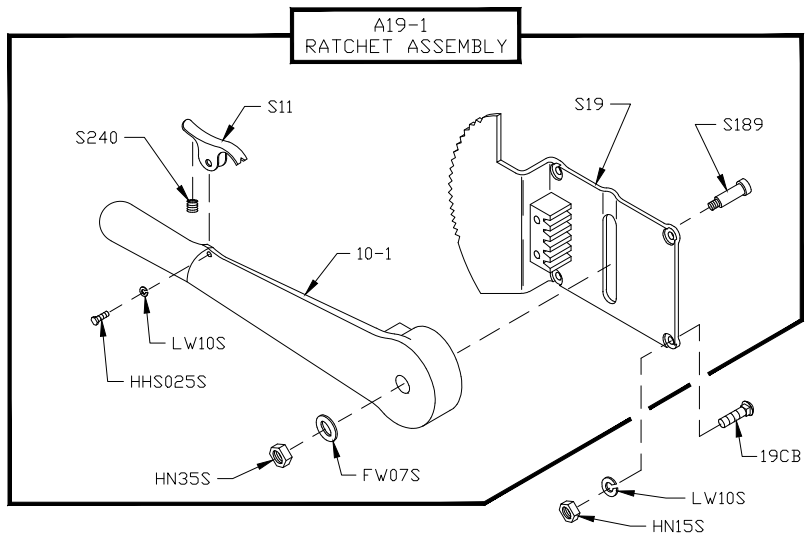

Item No.	Description	Item No.	Description
A19-1	Ratchet assembly	S11	Ratchet trigger SS
FW07S	Flat washer, 3/8 SS	S189	Ratchet arm stud SS
HHS025S	Hex head screw, 1/4-20 x 1/2 SS	S19	Ratchet base SS
HN15S	Hex nut, 1/4-20 SS	S240	Ratchet trigger spring
HN35S	Hex nut, 3/8-16 SS	10-1	Ratchet arm
LW10S	Lock washer, 1/4 SS	19CB	Carriage bolt 1/4-20 SS

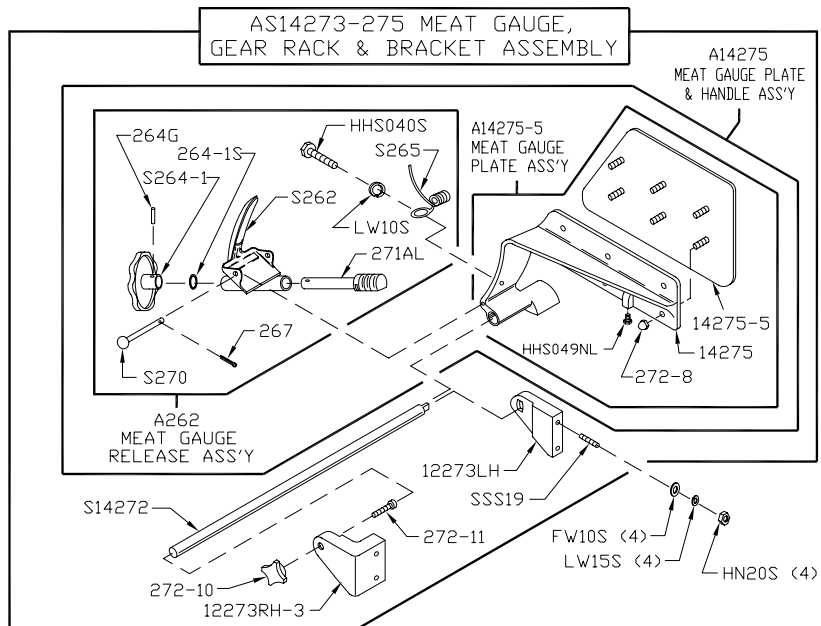

Item No.	Description	Item No.	Description
AS14273-275	Meat gauge assembly	S265	Meat gauge release spring, SS
A14275	Meat gauge plate assembly	S270	Meat gauge release pin, SS
A262	Meat gauge release assembly	12273LH	Meat gauge bracket- LH
FW10S	Flat washer, 5/16 SS	12273RH-3	Meat gauge bracket- RH
HHS040S	Hex head screw, 1/4-20 x 3/4 SS	14275	Meat gauge arm
HHS049NL	Hex screw- nylon, 5/16-18 x 1/2	14275-5	Meat gauge plate, SS
HN20S	Hex nut, 5/16-18 SS	264G	Meat gauge hand wheel groove pin
LW10S	Lock washer, 1/4 SS	264-1S	Hand wheel shim, SS
LW15S	Lock washer, 5/16 SS	267	Meat gauge release cotter key
SSS19	Set screw, cup point, 5/16-18 x 1-1/2 SS	271AL	Meat gauge worm gear, Aluminum
S14272	Meat gauge gear rack, SS	272-8	Cap nut, 5/16-18, SS
S235	Taper pin, 4 x 3/4 SS	272-10	Lock knob 3/8-16, 4 point
S262	Meat gauge release handle, SS	272-11	Allen head cap screw 3/8-16 x 1-1/2
S264-1	Meat gauge hand wheel, SS		

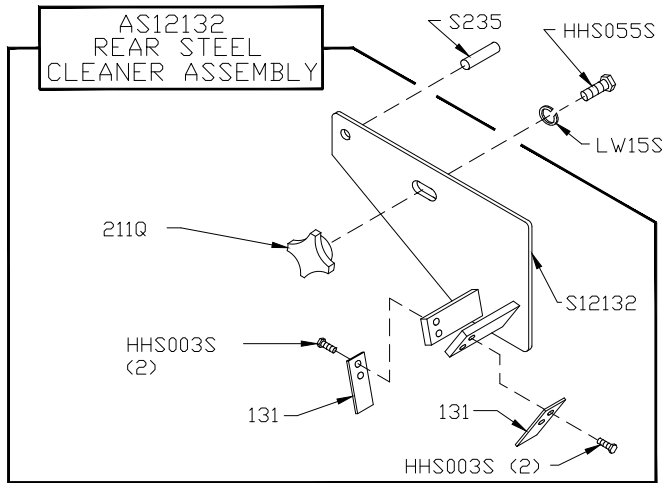

Item No.	Description
AS12132	Steel cleaner assembly, rear
AS12290-3	Cleaning unit assembly
A295	Wheel cleaner assembly
HHS003S	Hex head screw, 8-32 x 1/4 trimmed, SS
HHS004S	Hex head screw, 8-32 x 3/8, SS
HHS009S	Hex head screw, 10-24 x 1/4, SS
HHS055S	Hex head screw, 5/16-18 x 3/4, SS
HN05S	Hex nut, 8-32 SS
LW15S	Lock washer, 5/16 SS
S12132	Cleaning unit, rear
S12290-3	Cleaning unit
S229	Wheel cleaner arm spring, SS

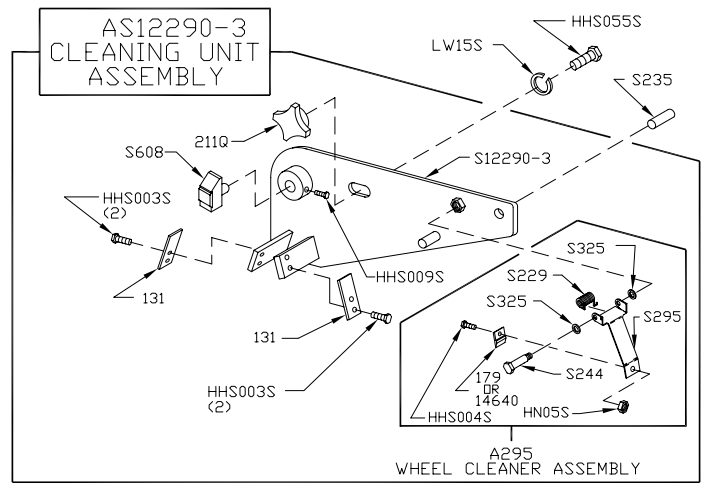

Item No.	Description
S235	Taper pin, #4 x 3/4 SS
S244	Wheel cleaner arm stud, SS
S295	Wheel cleaner arm, SS
S325	Wheel cleaner arm stud washer, SS
S608	Saw back-up guide w/607 carbide
131	Blade cleaner, SS
131N	Blade cleaner, nyleen
131SHORT	Blade cleaner, Short SS, 1-9/16
131SS-NYL	Blade cleaner combo, Short, SS & Nyleen
179	Wheel cleaner
211Q	Lock knob, 5/16-18, 4 point
14640	Wheel cleaner, Rulon

Item No.	Description
AS116-2214	Saw guide bar assembly 22"
A14211	Finger lift assembly, removable
A602	Saw guide assembly, upper
FW06S	Flat washer, 1/4 SS
HHS015S	Hex head screw, 10-32 x 7/8, SS
HHS020S	Hex head screw, 1/4-20 x 3/8, SS
HHS083S	Hex head screw, 3/8-16 x 1-3/4, SS
HN10S	Hex nut, 10-32 SS
LW05S	Lock washer, #10 SS
LW10S	Lock washer, 1/4 SS
RHS10S	Round head screw, 10-32 x 3/4 SS
RHS30S	Round head screw, 1/4-20 x 7/8 SS
S200B1	Stop stud on guide bar
S116-22	Saw guide bar, 22" SS
14255	Saw guard
17211-22	Finger lift shim, .022
17211-35	Finger lift shim, .035
194	Saw guide bar lock pad, brass
194KS-1	Saw guide bar lock knob assembly
211	Finger lift bracket
211A-291Q	Fastener knob, 4 point
601	Upper saw guide bracket
602B	Upper saw guide with carbide
602AFSC	Upper saw guide, narrow, fish
708	Decal "DANGER EXPOSED BLADE"

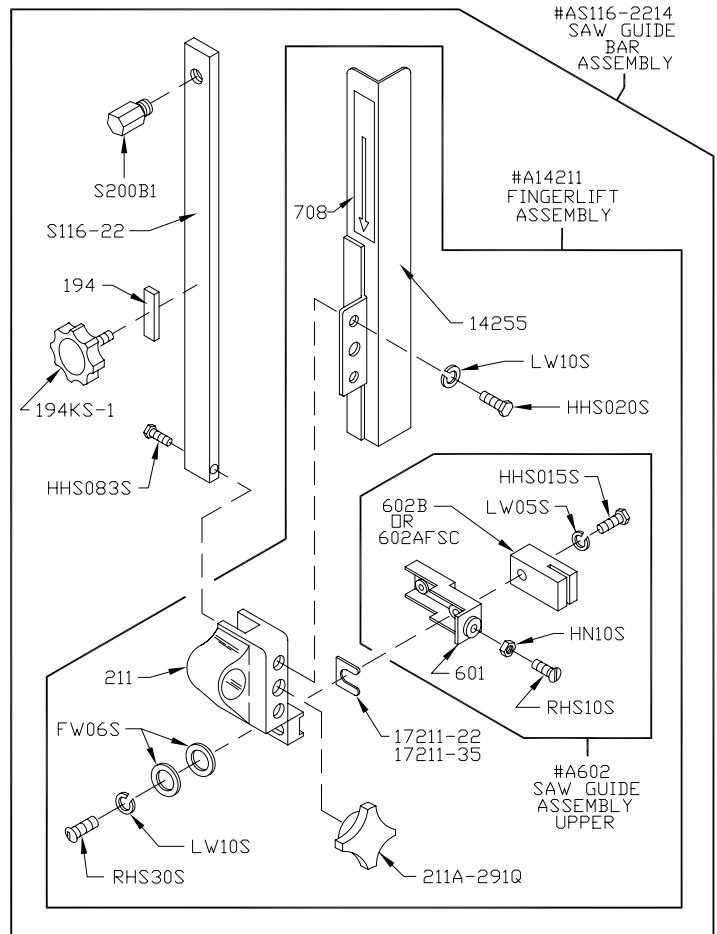

**AS415D
STATIONARY BAR ASSEMBLY**

Item No.	Description
AS415D	Stationary bar assembly, SS
HHS025S	Hex head screw, 1/4-20 x 1/2, SS
LW10S	Lock washer, 1/4, SS
S268	Stationary bar headless screw
S119A	Saw guide in stationary bar, SS
177	Nylon filler
S415D	Stationary bar, SS

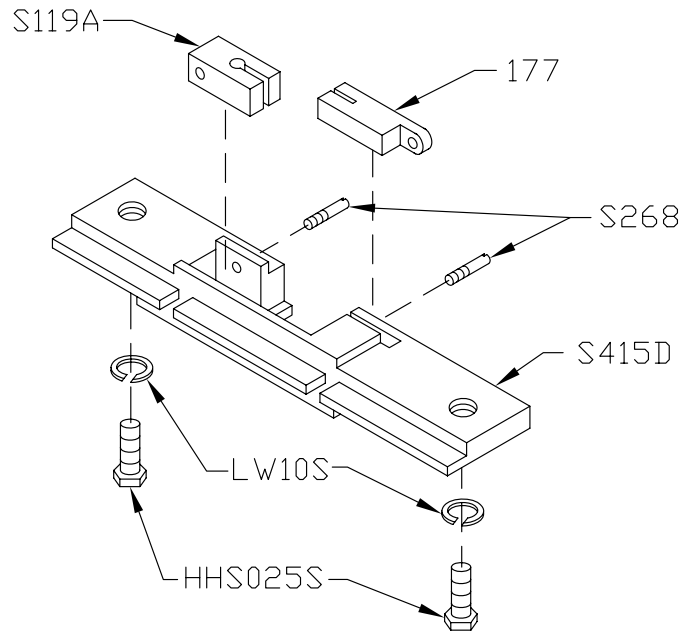

**A16196
TENSION
SPRING
ASSEMBLY**

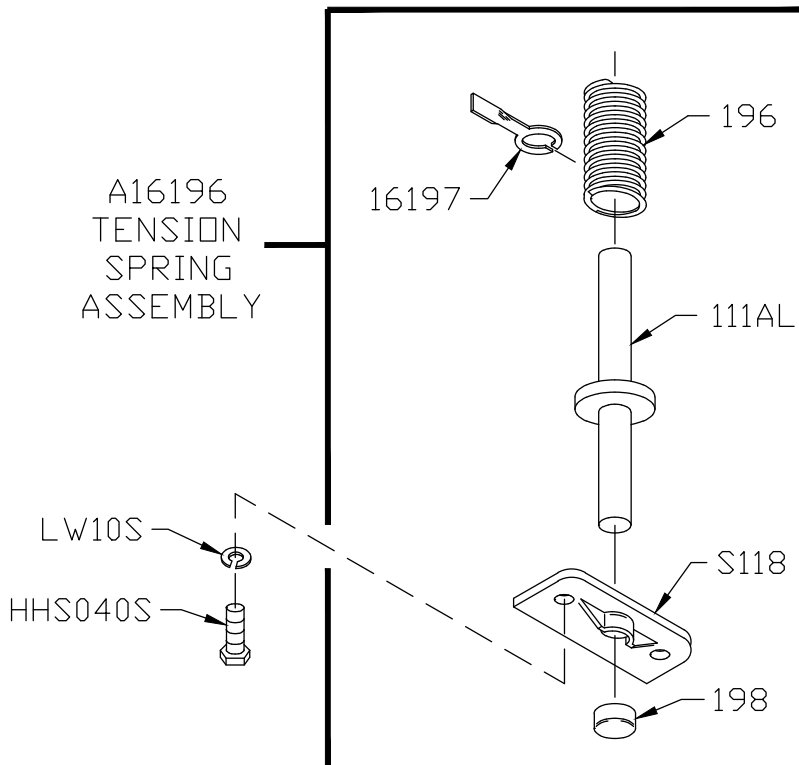

Item No.	Description
A16196	Tension spring assembly
HHS040S	Hex head screw, 1/4-20 x 3/4 SS
LW10S	Lock washer, 1/4 SS
S118	Tension spring plate, SS
111AL	Tension spring pin
16197	Tension spring gauge
196	Saw tension spring
198	Tension pin cap

**A16155EZ
EASY FLOW
MEAT CARRIAGE ASSEMBLY**

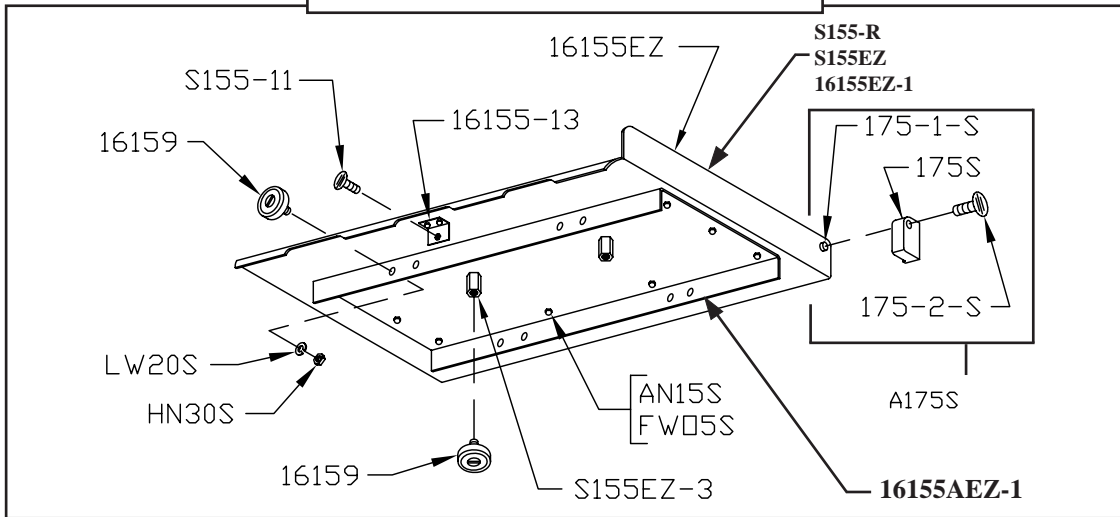

Item No.	Description	Item No.	Description
A16155EZ	Meat carriage assembly complete, EZ flow	S155EZ-3	Hex standoff, EZ flow carriage
A175S	Thumb guard assembly	16155EZ	Meat carriage top & angle only
FW05S	Flat washer, 1/4 SS	16155EZ-1	Meat carriage top only w/ weld studs (DNS)
AN15S	Acorn nut, 1/4-20 SS	16155-13	Carriage stop angle SS
HN30S	Hex nut, 3/8-16 light jam SS	16155AEZ-1	Meat carriage angle plate
LW20S	Lock washer, 3/8 regular SS	16159	Meat carriage bearing SS
S155-11	Meat carriage stop thumb screw	175S	Thumb guard, nylon
S155-R	Raw meat carriage top only (DNS)	175-1-S	Thumb guard nut, SS
S155EZ	Meat carriage top only (NSS)	175-2-S	Thumb screw, 1/4-20 x 1/2, SS

**AS16120EZ
CHANNEL ASSEMBLY
EZ FLOW**

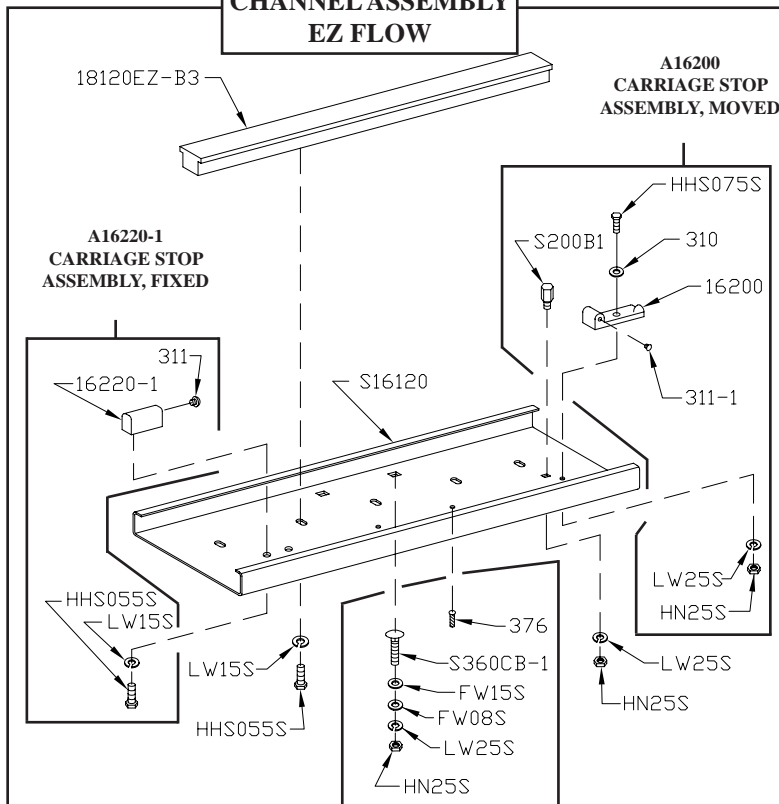

Item No.	Description
A16200	Channel stop assembly, movable
A16220-1	Channel stop assembly, fixed
AS16120EZ	Channel assembly with center guide
FW08S	Flat washer, 3/8, SS
FW15S	Flat washer, 1/2, SS
HHS055S	Hex head screw, 5/16-18 x 3/4 SS
HHS075S	Hex head screw, 3/8-16 x 1-1/4 SS
HN25S	Hex nut, 3/8-16 SS
LW15S	Lock washer, 5/16 SS
LW25S	Lock washer, 3/8 SS
S16120	Channel, SS
S200B1	Stop stud, carriage stop, SS
S360CB-1	Carriage bolt, 3/8-16 x 1-1/4, SS
16200	Carriage stop, movable w/ #311-1
16220-1	Carriage stop, fixed w/ #311
18120EZ-B3	Guide bar, EZ flow, T-shaped
310	Waved washer, movable carriage stop
311	Rubber bumper for #16220-1 stop
311-1	Rubber bumper for #16200 stop
376	Drive screw, 10 x 1/2, SS

**WATERTIGHT MAGNETIC SWITCH ASSEMBLIES
(AEG)**

INCLUDES MOUNTING BRACKET AND WIRES

Item No.	Description	Item No.	Description
A22616EE-514	BAEG/MS-PB/05-C8 2HP 208-220-50/60-3	A22616EE-5241	BAEG/MS-PB/A26 1.5-2HP 104/115-60-1
A22616EE-516	BAEG/MS-PB/05-E4.7 2HP 440/460-3	A22616EE-5261	BAEG/MS-PB/CS16 2HP 230-60-1
A22616EE-518	BAEG/MS-PB/05-D4.7 1.5-2HP 380/415-50-3	A22616EE-530	BAEG/MS-PB/05-F3.2 2HP 550/575-3
A22616EE-522	BAEG/MS-PB/05-C14 3HP 220-230-50/60-3	A22616EE-534	BAEG/MS-PB/05-E6.3 3HP 440/460-60-3
A22616EE-5221	BAEG/MS-PB/05-CS14 1.5HP 220/230-50/60-1	A22616EE-536	BAEG/MS-PB/05-D8 3HP 380-60-3

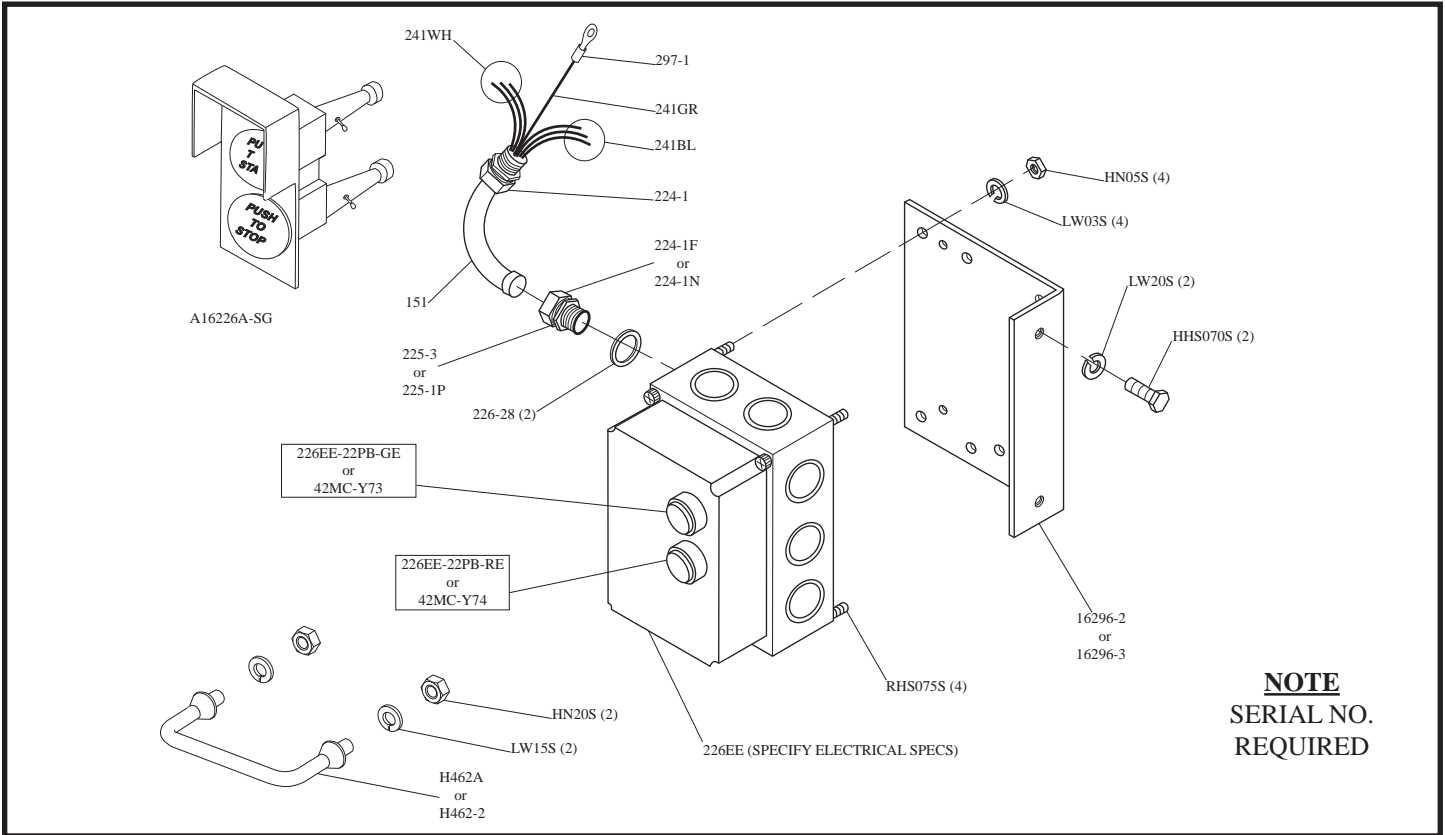

Item No.	Description
A16226A-SG	Green/red switch button assembly
H462A	Guard assembly for switch buttons
HHS070S	Hex head screw, 3/8-16 x 1, SS
HN05S	Hex nut, 8-32 SS
HN20S	Hex nut, 5/16-18 SS
LW03S	Lock washer, #8 SS
LW15S	Lock washer, 5/16 SS
LW25S	Lock washer, 3/8 heavy SS
RHS075S	Round head screw, 8-32 x 3/4 SS
14256	Junction box, plastic w/ cover
14257	Junction box, metal
14258	Junction box cover, metal
16296-2	Switch bracket, SS
151	Watertight conduit
225-3	Conduit connector, WT, 45°
226EE-ENCL	Enclosure w/ pushbutton, 30mm holes
-PB22	
226EE-OL02.4H	Overload, B05-H, 1.7-2.4A
226EE-OL4I	Overload, B18K-I, 2.5-4A
H281EE-51	Overload, B18K-K, 4-6.3A
226EE-OL08.5L	Overload, B18K-L, 5.5-8.5A
226EE-OL12M	Overload, B18K-M, 8-12A
H281EE-31	Overload, B18K-N, 10-16A
226EE-OL26ON	Overload, B18K-ON, 21-26A

Item No.	Description
226EE-AO11K	Contact, LS11K.11S-AO, 120V
226EE-CO11K	Contact, LS11K.11S-CO, 208-230V
226EE-EO11K	Contact, LS11K.11S-EO, 380-415V-50hz
226EE-FO11K	Contact, LS11K.11S-FO, 575V
226EE-22PB-GE	Start P/B, 22mm Ext w/ NO contact block
226EE-22PB-GF	Start P/B, 22mm Flush w/ NO contact block
226EE-22PB-RE	Stop P/B, 22mm Flush w/ NC contact block
226EE-514	BAEG/MS-PB/05-C8 2HP 220-50/60-3
226EE-516F	BAEG/MS-PB/05-E4.7 1-1/2-2HP 440-60-3
226EE-518	BAEG/MS-PB/05-D4.7 2HP 380-50-3
226EE-5221	BAEG/MS-PSF/05-CS14 1.5HP 230-50/60-1
226EE-5241	BAEG/MS-PB/A26 2HP 120-60-1
226EE-5261	BAEG/MS-PB/CS16 2HP 230-60-1
226EE-530	BAEG/MS-PB/05-F3.2 2HP 550-60-3
226EE-534	BAEG/MS-PB/05-E6.3 3HP 440-60-3
226EE-536	BAEG/MS-PB/05-D8 3HP 380-50-3
226-28	Washer, 1-1/2 x 27/32 SS
241BL	Wire, Black, 12 GA., CSA & UL
241GR	Wire, Green, 12 GA., CSA & UL
241RD	Wire, Red, 12 GA., CSA & UL
241WH	Wire, White, 12 GA., CSA & UL
297-1	Wire terminal eyelet, 12 GA.
42MC-Y73	Green start button, 30mm
42MC-Y74	Red stop button, 30mm

115 VOLT WITH 6 LEADS

SCHMATIC USING 1 PH AEG LS11K CONTACTOR WITH B18K OVERLOAD
 W.T. SWITCH FOR 115 VOLT, SINGLE PHASE, 60 CYCLE WEG MOTOR 1-1/2HP WITH
 6 MOTOR LEADS

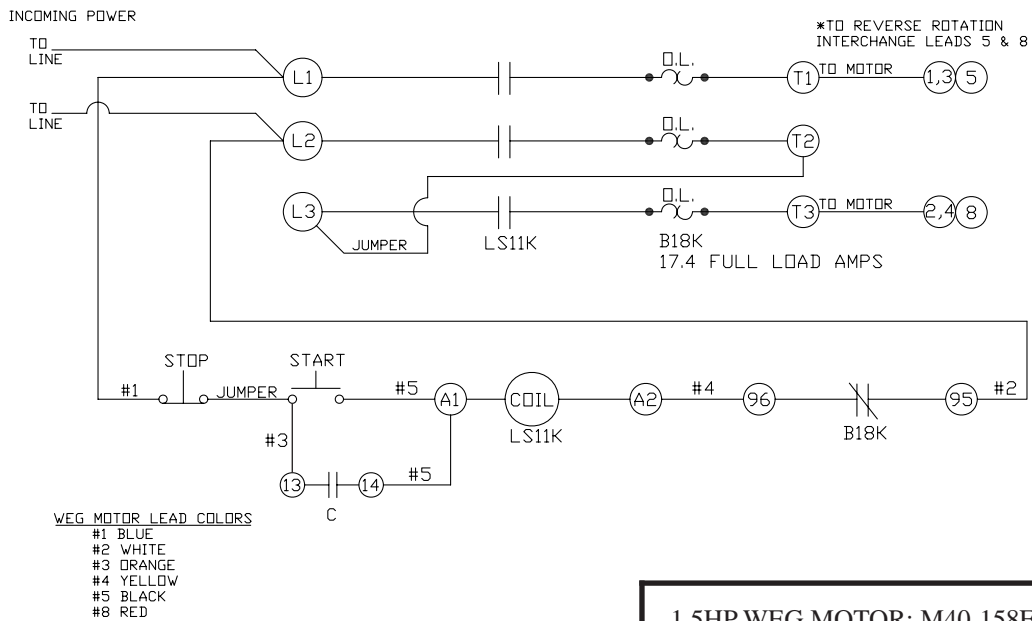

208-230 VOLT WITH 6 LEADS

SCHMATIC USING 1 PH AEG LS05 CONTACTOR WITH B05 OVERLOAD
 W.T. SWITCH FOR 208-230 VOLT, SINGLE PHASE, 60 CYCLE WEG MOTOR 1-1/2 HP WITH
 6 MOTOR LEADS

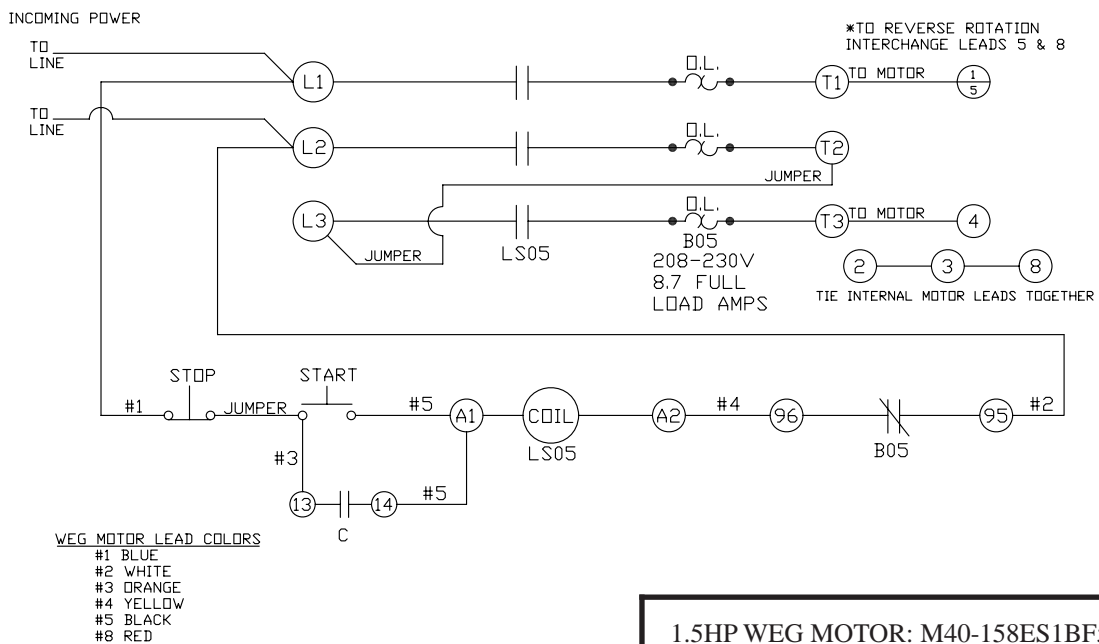

-115 VOLT WITH 7 LEADS-

SCHEMATIC USING 3-POLE AEG WATERTIGHT SWITCH WITH JUMPER TO ELIMINATE BREAKING EFFECT OF MOTOR AFTER STOP IS ENGAGED. 2HP/60HZ/1PH BALDOR MOTOR WITH 7 MOTOR LEADS, WIRED FOR 115 VOLTS

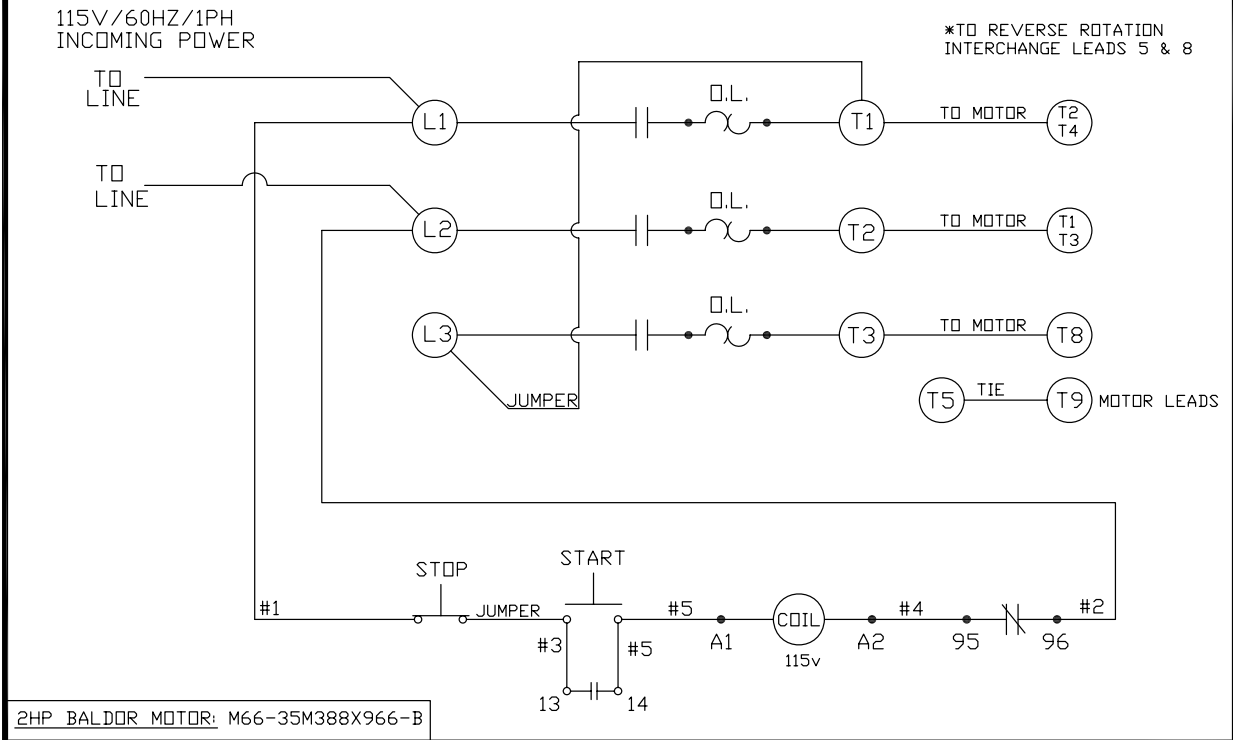

-230 VOLT WITH 4 LEADS-

SCHEMATIC USING 3-POLE AEG WATERTIGHT SWITCH WITH JUMPER TO ELIMINATE BREAKING EFFECT OF MOTOR AFTER STOP IS ENGAGED. 2HP/50HZ/1PH BALDOR MOTOR WITH 4 MOTOR LEADS, WIRED FOR 230 VOLTS

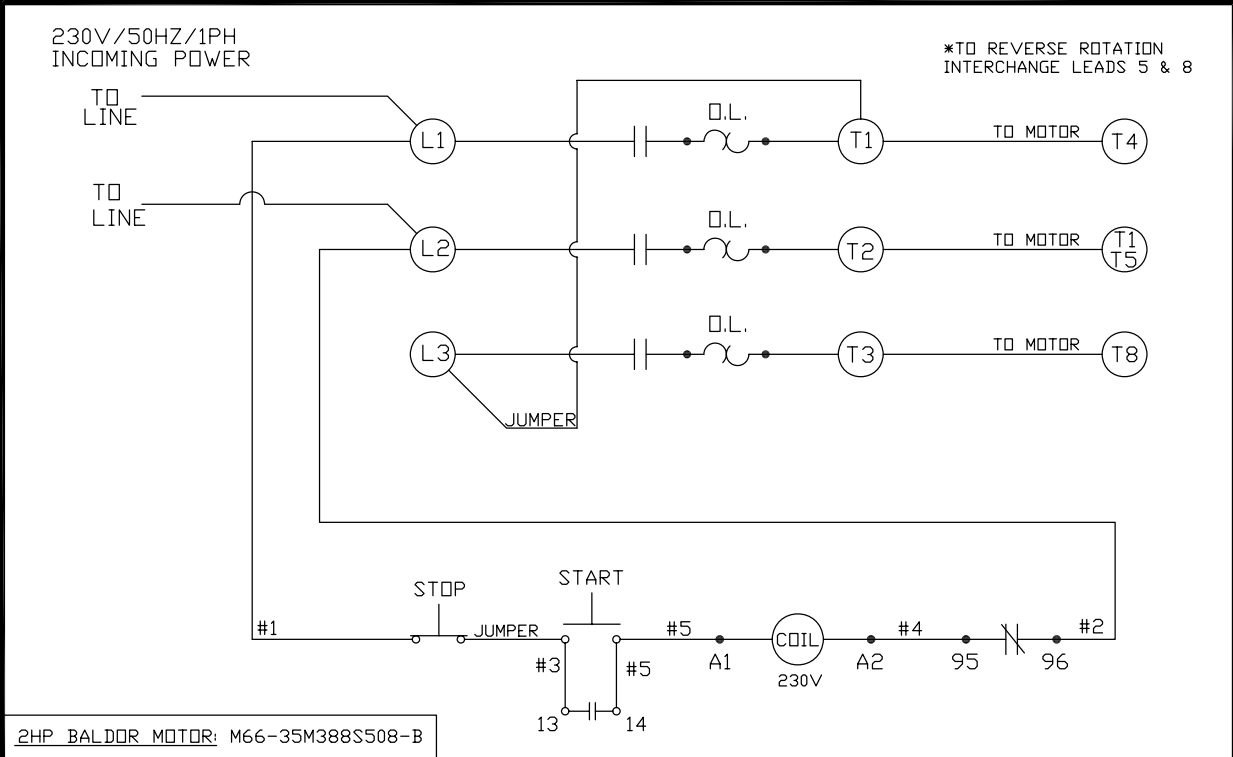

-230 VOLT WITH 7 LEADS-

SCHEMATIC USING 3-POLE AEG WATERTIGHT SWITCH WITH JUMPER TO ELIMINATE BREAKING EFFECT OF MOTOR AFTER STOP IS ENGAGED. 2HP/60HZ/1PH BALDOR MOTOR WITH 7 MOTOR LEADS, WIRED FOR 230 VOLTS

230V/60HZ/1PH
INCOMING POWER

*TO REVERSE ROTATION
INTERCHANGE LEADS 5 & 8

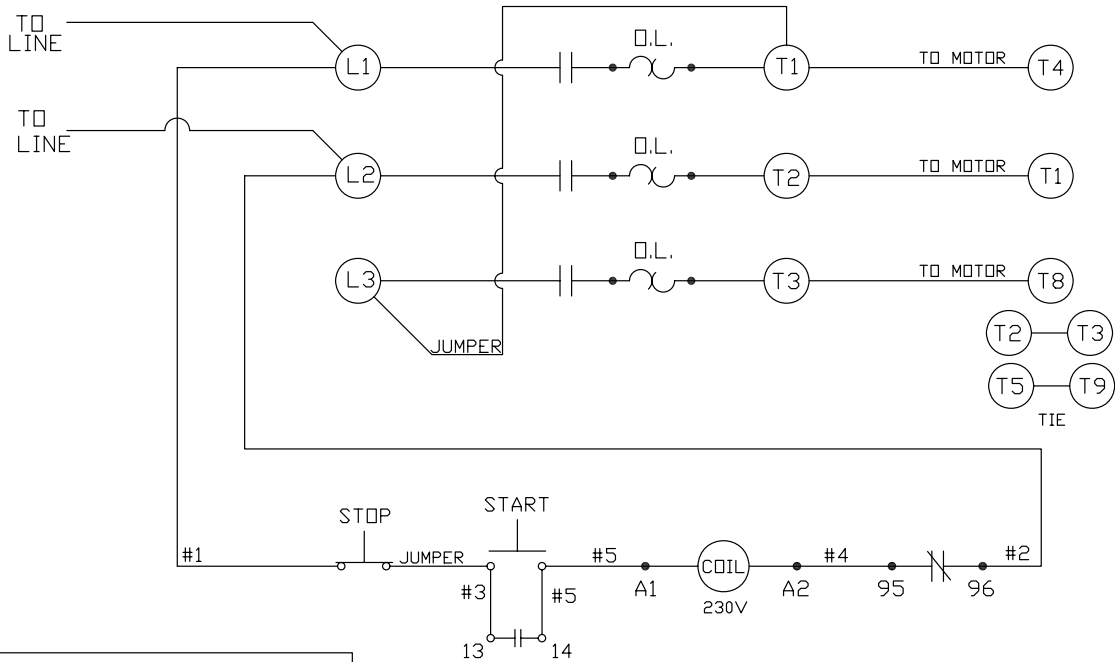

2HP BALDOR MOTOR: M66-35M388X966-B

208-230 VOLT WITH 9 LEADS-

SCHEMATIC USING 3-POLE AEG W.T. SWITCH 2HP/50/60HZ/3PH WEG MOTOR WITH 9 MOTOR LEADS WIRED FOR 208-230 VOLTS

208-230V/50/60HZ/3PH
INCOMING POWER

TO LINE

TO LINE

TO LINE

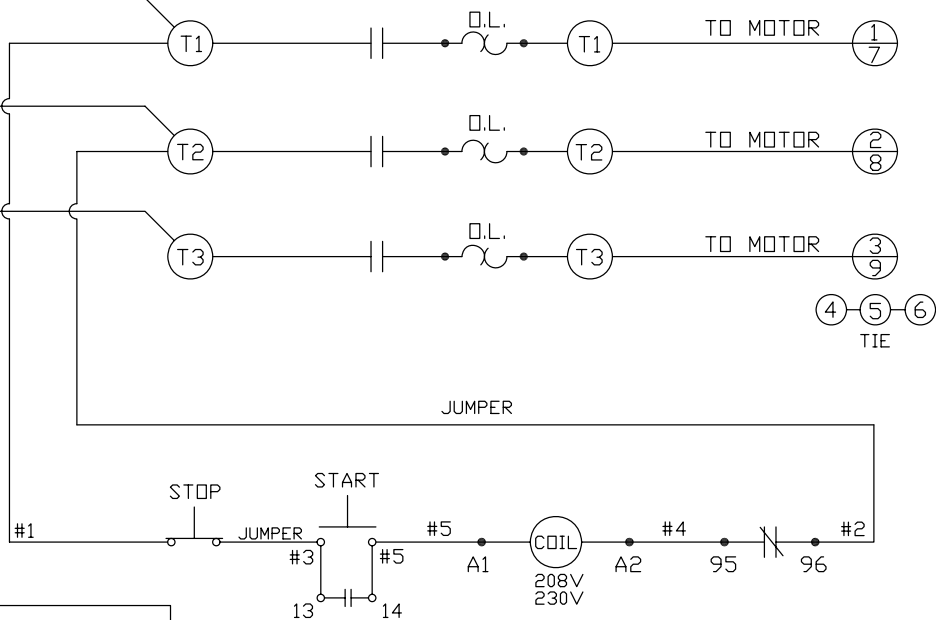

2HP WEG MOTOR: M68-218ET3E145T-W

208-220-230 VOLT 3 PHASE WITH 9 LEADS-
 SCHEMATIC USING 3-POLE STROMBERG OR AEG W.T. SWITCH
 2HP/60HZ/3PH BALDOR MOTOR WITH 9 MOTOR LEADS
 WIRED FOR 208-220-230 VOLTS

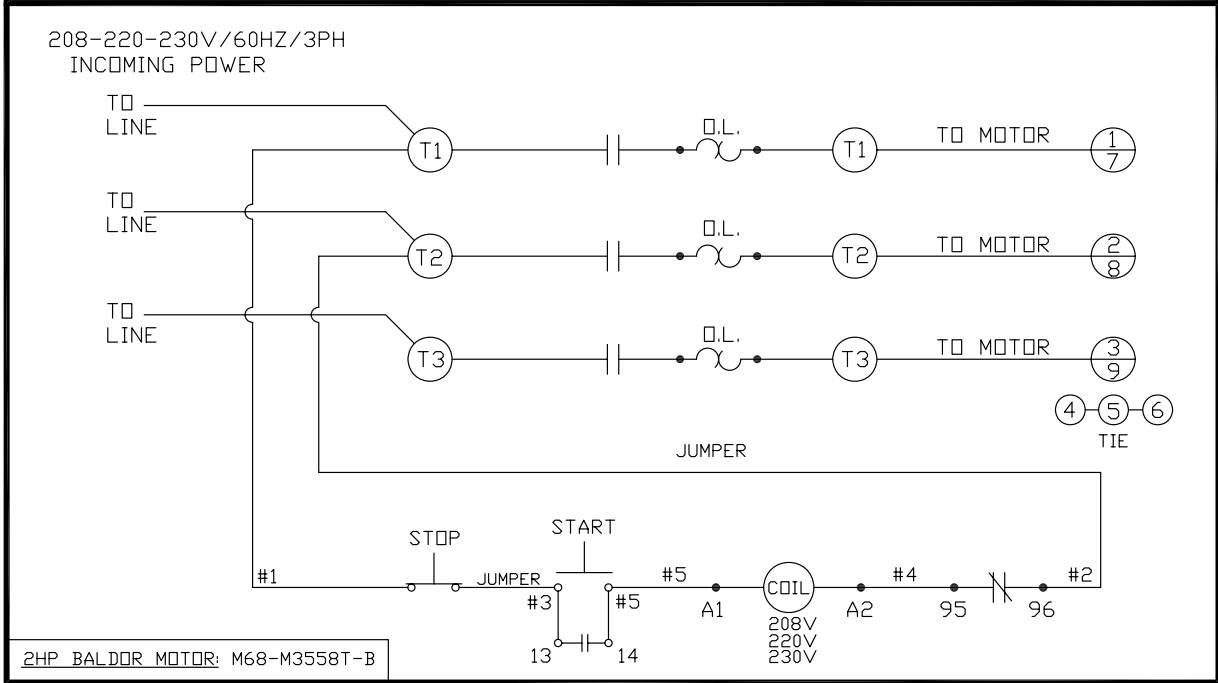

-220 VOLT 3 PHASE WITH 12 LEADS-

SCHEMATIC USING 3-POLE STROMBERG OR AEG W.T. SWITCH
 2HP/50HZ/3PH BALDOR MOTOR WITH 12 MOTOR LEADS WIRED FOR 220 VOLTS

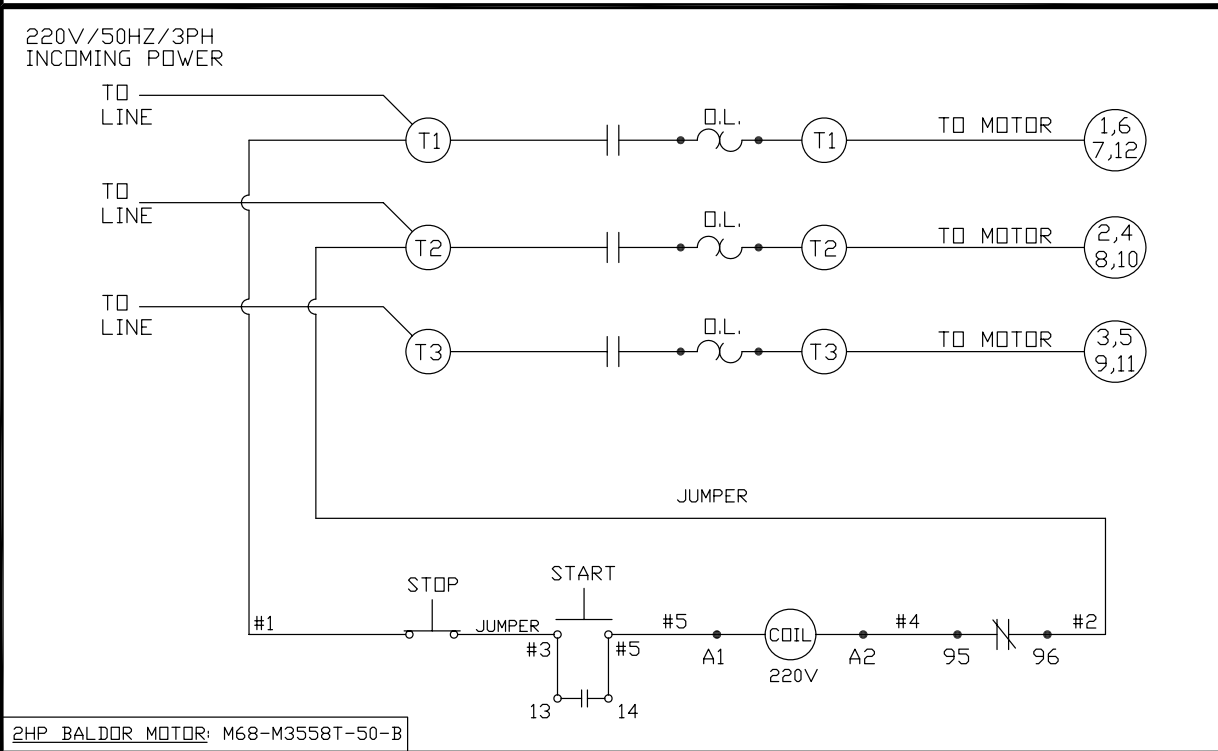

380-460 VOLT WITH 9 LEADS

SCHEMATIC USING 3-POLE AEG W.T. SWITCH
 2HP/50/60HZ/3PH WEG MOTOR WITH 9 MOTOR LEADS WIRED FOR 380-460 VOLTS

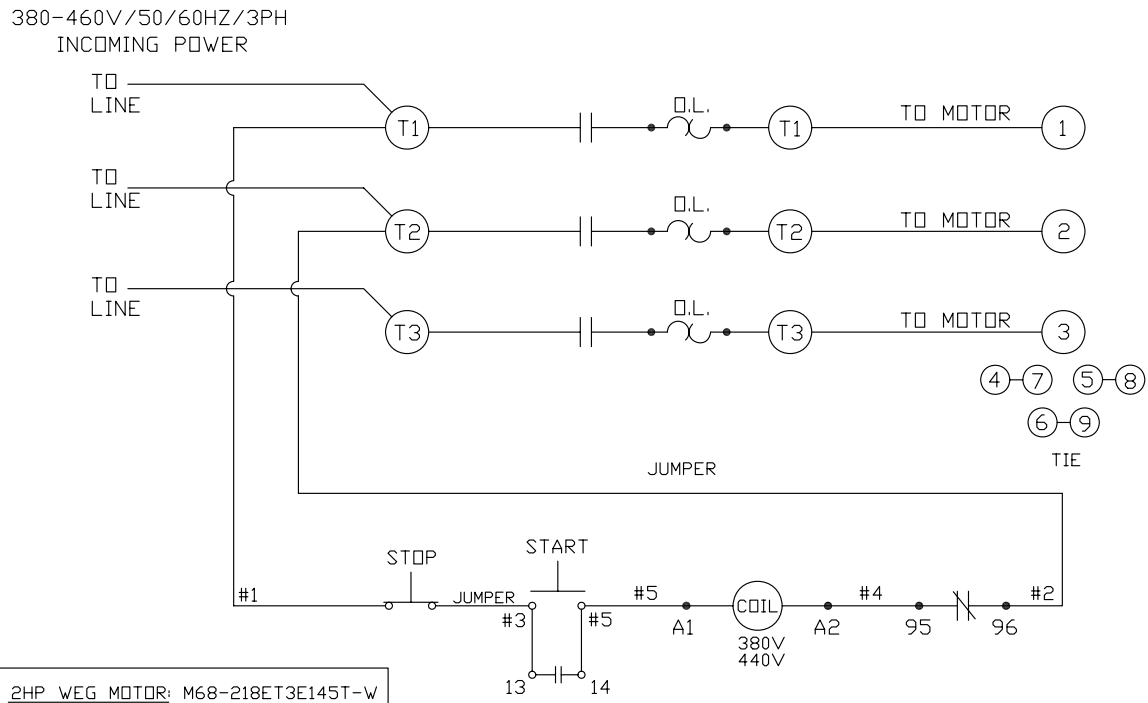

-380 VOLT, 3 PHASE WITH 12 LEADS-

SCHEMATIC USING 3-POLE STROMBERG OR AEG W.T. SWITCH
 2HP/50HZ/3PH BALDOR MOTOR WITH 12 MOTOR LEADS WIRED FOR 380 VOLTS

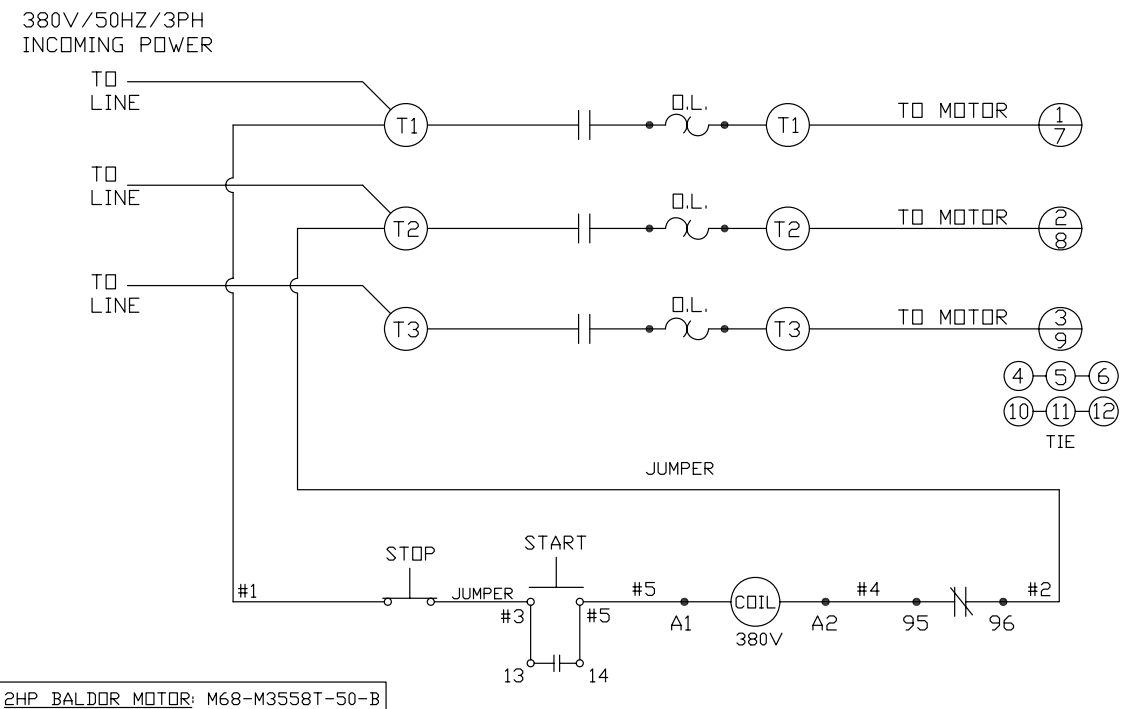

440-460 VOLT 3 PHASE WITH 9 LEADS-
 SCHEMATIC USING 3-POLE STROMBERG OR AEG W.T. SWITCH
 2HP/60HZ/3PH BALDOR MOTOR WITH 9 MOTOR LEADS
 WIRED FOR 440-460 VOLTS

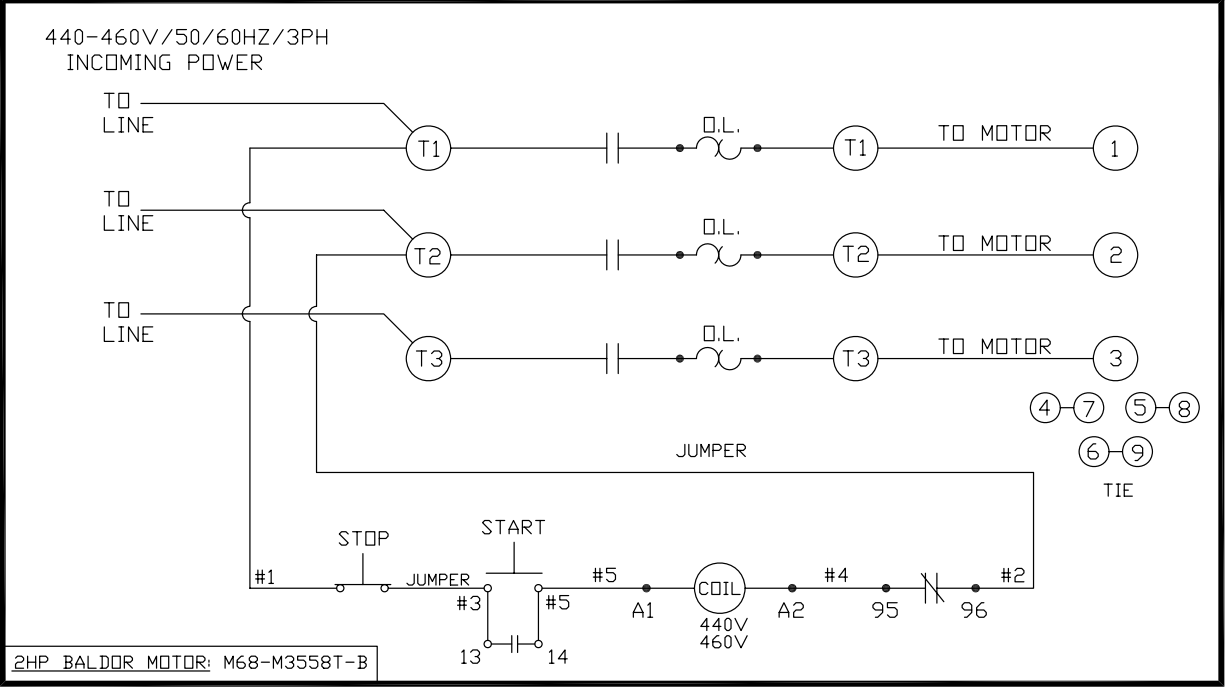

-440 VOLT, 3 PHASE WITH 12 LEADS-
 SCHEMATIC USING 3-POLE STROMBERG OR AEG W.T. SWITCH
 2HP/50HZ/3PH BALDOR MOTOR WITH 12 MOTOR LEADS WIRED FOR 440 VOLTS

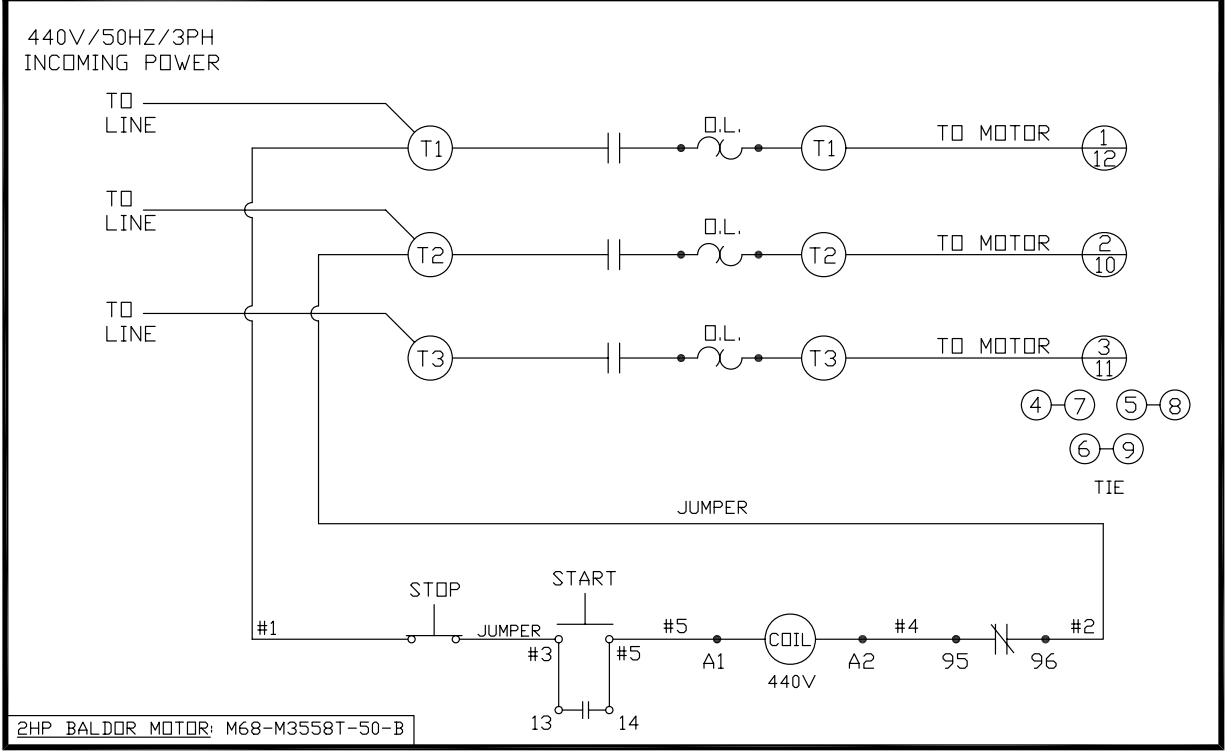

WARNING LABEL LOCATIONS ON MACHINE

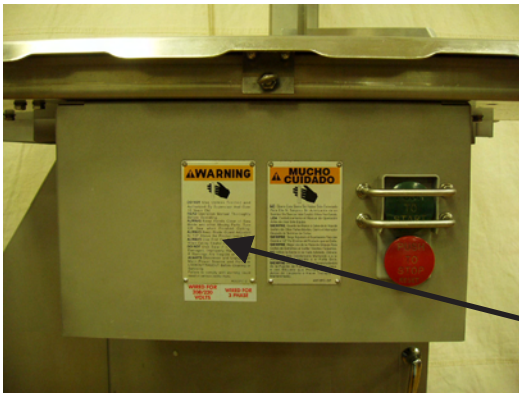

ATTACH TO CHANNEL BRACKET NEXT TO SWITCH BUTTONS



ATTACH ON HEAD STRUCTURE BELOW MODEL/SERIAL NUMBER TAG

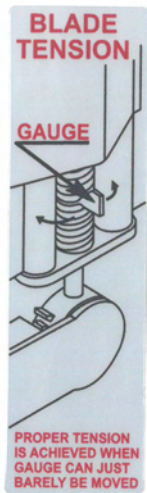

P/N 710 "BLADE TENSION" DECAL

ATTACH TO HEAD AS SHOWN



P/N 708 "DANGER EXPOSED BLADE" DECAL

ATTACHED TO SAW GUARD ON SAW GUIDE BAR

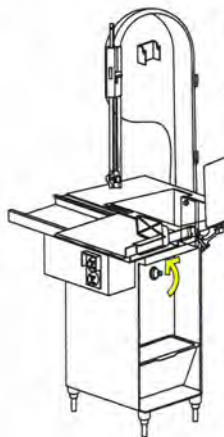

IMPORTANT

This saw has been electrically tested at the factory, but electrical phasing for proper rotation may not match your electrical supply.

WITH LOWER SAW WHEEL REMOVED, check rotation of shaft. Rotation must be **counterclockwise** when facing shaft.

Failure to confirm correct rotation could result in the wheel dislodging.

16716

P/N 16716 "CAUTION" LABEL USE ON MACHINES WITH REMOVABLE LOWER WHEEL

ATTACH TO HINGED RIGHT BASE DOOR



**WEARABLE SAW PARTS THAT WILL FIT BIRO POWER CUTTERS
MODELS**

11-22-1433-33-34-3334-44-4436-55

— EXCEPT WHERE NOTED OTHERWISE —

**CONTACT YOUR NEAREST BIRO AUTHORIZED DISTRIBUTOR
OR CONTACT BIRO MANUFACTURING**

PH.: 419-798-4451 E-Mail: service@birosaw.com



Item No. 130
SAW CLEANER BRACKET
ALL SAWS



Item No. 131
STEEL BLADE CLEANER
ALL SAWS



Item No. 159
CARRIAGE BEARING
11-22-33



Item No. 16159
CARRIAGE BEARING
1433-34-3334-44-55

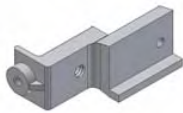

Item No. 601
UPPER SAW GUIDE BRACKET
ALL SAWS



Item No. 602B
UPPER SAW GUIDE
W/BEVELED CARBIDE
ALL SAWS



Item No. S265
MEAT GAUGE SPRING
ALL SAWS

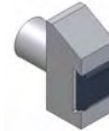

Item No. S608
LOWER BLADE BACKUP
W/CARBIDE
22 (after S/N 35301)-1433-55



Item No. 119A
LOWER SAW GUIDE
ALL SAWS



Item No. 177
NYLON FILLER
ALL SAWS

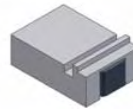

Item No. 604
LOWER BLADE BACKUP
W/CARBIDE
11-22 (before S/N 35300)

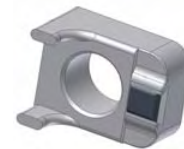

Item No. 605
LOWER BLADE BACKUP
W/CARBIDE
34-3334-44-4436

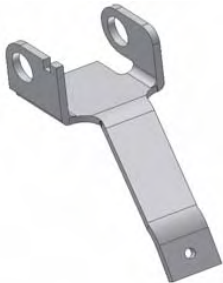

Item No. S295
WHEEL CLEANER ARM
ALL SAWS

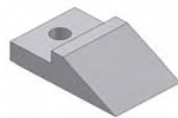

Item No. 179
WHEEL CLEANER
ALL SAWS



Item No. S244
WHEEL CLEANER ARM STUD
ALL SAWS



Item No. S229
WHEEL CLEANER
ARM SPRING
ALL SAWS



Item No. S268
FILLER & GUIDE STUD
ALL SAWS

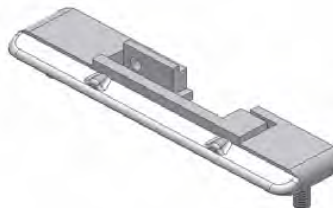

Item No. 415D
STATIONARY BAR
ALL SAWS

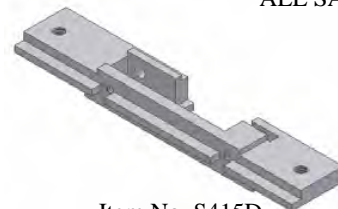

Item No. S415D
STAINLESS STATIONARY BAR
STD: 22 (after S/N 35301)-1433-55
OPT: 3334-44

USE PARTS REPAIR KIT PART NO. 12700-2

MODEL 1433 PART NUMBERS AND DESCRIPTIONS
MODEL NO. AND SERIAL NO. REQUIRED
WHEN ORDERING PARTS

Item no.	Description	Item no.	Description
HHS049NL	Hex screw, nylon, 5/16-18 x 1/2	12273RH-3	Meat gauge bracket, RH
M66-35M388S508-B	Motor, 2HP 230-50-1 open	12700-2	Wearable parts replacement kit
M66-35M388X966-B	Motor, 2HP 115/230-60-1 open	131	Saw cleaner, SS
M68-M3558T-B	Motor, 2HP 208-230/440-460-60-3 TEFC	14TP	Head door hinge pin, long, 1-1/2"
S11	Ratchet trigger, SS	14TP-1	Head door hinge pin, short, 1-1/4"
S116-22	Saw guide bar 22", SS	14003U-6	Upper wheel, 14"
S118	Tension spring plate, SS	14003UDF-6	Upper wheel, 14", double flange
S119A	Saw guide in stationary bar	14212W	Platter rod
S12132	Cleaning unit, rear	14232	Scrap bucket
S12290-3	Front blade, wheel cleaning unit	14255	Saw guard on saw guide bar w/ 708 decal
S12335X	Upper wheel hinge plate, SS	14256	Junction box
S14005C	Head, SS	14275	Meat gauge arm
S14006	Head door, SS	14275-5	Meat gauge plate, SS
S14007	Channel bracket, SS	14301-B	Name & model plate (Serial number req'd)
S14214	Side platter bracket, SS	14302HT	Saw blade, 108"
S14217PD	Base door left, SS, bolt on	14313-266	Operating and service manual
S14217R	Base door right, SS, hinged	14544	Grease seal, 1.50 ID
S14272	Meat gauge gear rack, SS	14545	Retaining ring, internal, 2-7/16 ID
S14239	Base, SS (DNS)	14548	Grease seal, 7/8 ID
S155-11	Meat carriage stop thumb screw, SS	14549	Lower bearing housing cap
S155B-1	Meat carriage stop, welded	14550	Adjustment screw, lower bearing housing
S155EZ-3	Hex stand off	14551	Hex jam nut, 5/8-11, SS
S16120	Channel	14560	Lower saw wheel, removable
S163F	Platter spacer weld button, SS	14560DF	Lower saw wheel, removable, double flange
S189	Ratchet arm stud, SS	14746	T-handle lock, removable lower wheel
S19	Ratchet base, SS	150	Conduit, flexible metal, per inch
S200B1	Stop stud on saw guide bar	151	Conduit, watertight, per inch
S217C	Base door hinge pin, long, SS	16112	Head door latch
S217E	Base door hinge pin, short, SS	16155EZ	Meat carriage, EZ flow
S229	Wheel cleaner arm torsion spring, SS	16159	Meat carriage bearing
S235	Taper pin, SS 4 x 3/4	16163B	Platter neck guard
S239-B40	Base foot welded, short, SS	16200	Carriage stop, movable
S239-B41-4	Adjustable leg bolt, SS	16220-1	Carriage stop, fixed
S240	Ratchet trigger spring, SS	16251-90X78AL	Upper V-belt pulley, 9 x 7/8, aluminum
S242R	Base door lock, right, SS	163A	Platter rod clip
S244	Wheel cleaner arm stud, SS	16517	Inner race spacer, removable wheel
S249	Base door handle	16543	Lower shaft
S253	Upper wheel aligning screw, SS	16547	Lower bearing housing, removable wheel
S262	Meat gauge release handle, SS	17211-22	Finger lift shim, .022
S264-1	Meat gauge release hand wheel	17211-35	Finger lift shim, .035
S265	Meat gauge release spring, SS	175-1-S	Thumb guard nut
S268	Stationary bar headless screw, SS	175-2-S	Thumb guard screw 1/4-20
S270	Meat gauge release pin w/ holes, SS	175S	Thumb guard, nylon
S295	Wheel cleaner arm, SS	177	Stationary bar nylon filler
S325	Wheel cleaner arm washer, SS	179	Wheel cleaner
S360CB-1	Carriage bolt, 3/8-16 x 1-1/4, SS	18120EZ-B3	Guide bar, EZ flow, T-shaped
S415D	Stationary bar, SS	19CB	Ratchet base carriage bolt, 3/8-16 x 1-3/4
S416	Platter locator weld pin, SS	194	Saw guide bar lock pad, brass
S608	Lower blade back-up guide w/ carbide	194KS-1	Saw guide bar lock knob assembly
10-1	Ratchet arm	196	Saw tension spring
111AL	Tension spring pin	197	Tension spring gauge
112-212	Waved washer	198	Cap, tension spring pin
119FSC	Saw guide in stationary bar, fish	211	Finger lift bracket
12273LH	Meat gauge bracket, LH		

MODEL 1433 PART NUMBERS AND DESCRIPTIONS (Cont.)

Item no.	Description	Item no.	Description
211A-291Q	Finger lift fastener knob, 4-point	271AL	Meat gauge worm gear, Aluminum
211D	Finger lift fastener bolt	272-8	Cap nut, 5/16-18
211Q	Fastener knob 4 pt., 5/16-18	272-10	Meat gauge lock knob, 4 point
212CP	Platter rod cotter pin	272-11	Lock knob socket screw
221-52	V-belt, 52"	280	Key
221-53	V-belt, 53"	310	Waved washer
224	Conduit connector, straight	311	Rubber bumper for #16220-1 stop
224-1	Conduit connector, WT, straight	311-1	Rubber bumper for #16200 stop
225	Conduit connector, 90 degree	324	Motor shim, 1/16"
225-1	Conduit connector, WT, 90 degree	324A	Motor shim, 1/8"
225-2	Conduit connector, 45 degree	331	Platter bracket rubber bumper
226-28	Conduit connector washer	340	Star lock washer
230DL	Upper shaft seal, double lip	360A1	Bearing housing angled grease fitting
231DL	Lower shaft seal, double lip	374	Shell Cassida grease EPS-2
234	Grease fitting, upper wheel	375	Drive screw for name plate
237	Upper shaft castellated lock nut	376	Drive screw, SS #10 x 1/2
238	Upper shaft castellated lock nut washer	4-30AL	Motor pulley, Al, 60cy, 5 x 3/4
247	Upper shaft	4-35AL	Motor pulley, Al, 60cy, 5 x 7/8
248	Upper wheel hub cap	4-45AL	Motor pulley, Al, 50cy, 6 x 3/4
252X	Upper shaft lock nut	4-49AL	Motor pulley, Al, 50cy, 6 x 7/8
256P	Safety pusher plate, composite	513	Upper wheel hub bracket
256PM	Safety pusher plate, aluminum	530	Retaining snap ring
259	Conduit anti-short bushing	601	Upper saw guide bracket
260	Aluminum slide gib	602AFSC	Saw guide, upper, fish
264G	Hand wheel groove pin	602B	Saw guide, upper
267	Meat gauge release cotter key	708	Decal "DANGER EXPOSED BLADE"
		71-1	Upper wheel hinge bracket

COMPLETE ASSEMBLIES FOR MODEL 1433

Item no.	Description	Item no.	Description
AS12132	Rear cleaning unit assembly	A14275	Meat gauge plate assembly
AS12290-3	Front cleaning unit assembly	A16112	Head door latch assembly
AS14005C	Head and door assembly	A16155EZ	Meat carriage assembly, EZ flow
AS14006	Head door assembly	A16196	Tension spring assembly
AS14217R	Base door assembly, hinged right	A16200	Carriage stop assembly, movable
AS16120EZ	Channel assembly, EZ flow	A16220-1	Carriage stop assembly, fixed
AS249R	Base door lock handle assembly, right	A16547	Lower bearing housing assembly without wheel
AS415D	Stationary bar assembly	A19-1	Ratchet assembly
A116-2214	Saw guide bar assembly	A227	Upper bearing cup/cone assembly
A14003U-6	Upper wheel assembly w/out hinge plate	A247	Upper shaft bearing assembly with spacer without wheel
A14003U335-6	Upper wheel assembly w/ hinge plate	A262	Meat gauge release assembly
A14163	Stationary platter assembly	A295	Wheel cleaner assembly
A14211	Fingerlift assembly with guard	A363	Lower bearing cup/cone assembly
AS14273-275	Meat gauge assembly	A71-1	Upper wheel hinge bracket assembly

OPERATOR'S NOTES

OPERATOR'S NOTES

LIMITED WARRANTY:

WARRANTY: The BIRO Manufacturing Company warrants that Model 1433 will be free from defects in material and workmanship under normal use and with recommended service. BIRO will replace defective parts, which are covered by this limited warranty, provided that the defective parts are authorized for return, shipping charges prepaid, to a designated factory for inspection and/or testing.

DURATION OF WARRANTY: The warranty period for all parts covered by this limited warranty is one (1) year from date of Inspection/Demonstration advised on the returned Warranty Registration Card, or eighteen (18) months from original factory ship date, whichever occurs first, except as noted below.

PARTS NOT COVERED BY WARRANTY: The following are **not** covered by this limited warranty: wearable parts on the cleaning system such as wheel cleaners (Item No. 179), saw blade cleaners (Item No. 131) blade backup guides (Item No's. 602B, 605 and S119A), and the nylon filler (Item No. 177). This limited warranty does not apply to machines sold as used, rebuilt, modified, or altered from the original construction in which the machine was shipped from the factory. (WATER CONTAMINATED ELECTRICAL SYSTEMS ARE NOT COVERED UNDER THIS LIMITED WARRANTY.) BIRO is not responsible for electrical connection of equipment, adjustments to switch controls or any other electrical requirements, which must be performed only by a certified electrician. BIRO is not responsible for service charges or labor required to replace any part covered by this limited warranty or for any damages resulting from misuse, abuse, lack of proper or recommended service.

EXCLUSION OF WARRANTIES AND LIMITATION OF REMEDIES: BIRO gives no warranties other than those expressly stated in this limited warranty. THE IMPLIED WARRANTY OF MERCHANTABILITY, THE IMPLIED WARRANTY OF FITNESS FOR PROCESSING FOOD PRODUCTS, AND ALL OTHER IMPLIED WARRANTIES ARE SPECIFICALLY EXCLUDED. BIRO IS NOT LIABLE FOR CONSEQUENTIAL OR INCIDENTAL DAMAGES, EXPENSES, OR LOSSES. THE REMEDIES PROVIDED IN THIS BIRO LIMITED WARRANTY ARE PURCHASER'S SOLE AND EXCLUSIVE REMEDIES AGAINST BIRO.

REGISTRATION CARDS: You must sign, date and complete the warranty registration card supplied with each machine. The warranty card must be returned to The BIRO Manufacturing Company for proper registration. If no warranty card is returned to BIRO, the warranty period will begin from the date the machine was originally shipped from the factory.

HOW TO GET SERVICE:

1. Contact the agency from whom you purchased the machine; or
2. Consult the yellow pages of the phone directory for the nearest authorized dealer; or
3. Contact Biro Manufacturing Company for the nearest authorized service entity in your area.

BIRO MANUFACTURING COMPANY

1114 W. Main St

Marblehead, OH 43440

Ph. 419-798-4451

Fax 419-798-9106

E-mail: Service@birosaw.com

Web: www.birosaw.com

Item No.: 14313-266

PTCT: MD 1433-266-3-16-12-B